

BRIMSON ZONE

Pit Name	Legal	Price/cy	Notify Public Works of Permit/ District		Locked, Key Needed	Comments/Special Conditions
Laine Road 532-12L	NE-SW 12-53-12	\$3.50	Y	5	Y	Sand and fine gravel, silty in spots. Rock for sale or use.
Ross Creek 523-04C	NE-NW 4-52-13	\$4.50	Y		Y	Gravel, small cobble. Two class-5 stockpiles on site: Public Works - Land Dept and Normanna Township. Avoid seep area on southeast bank. Potential Permits available later in Summer 2026.
Rossini Rd. (95) 542-21G	SW-NE 21-54-12	\$3.50	Y	5	Y	Clean sand, gravel, small cobble. Public Works stockpiles. Screened rock.
South Rd (aka Number 4) 555-01RS	SE-SE 1-55-15	\$3.50	Y	6	Y	Long term multipurpose pit. Next expansion expected to be east of the South Pit Road. Land Dept stockpile on site. No Permits Available in 2026.

Public Works Supervisors: Dist. #5 – Gordy Halverson Dist. #6 Gerald VanGuilder

- **Send pit maps to Public Works along with the permit.**

Review Date: 02/23/2026 (Tim,amm)



Brimson Zone

Gravel Pits

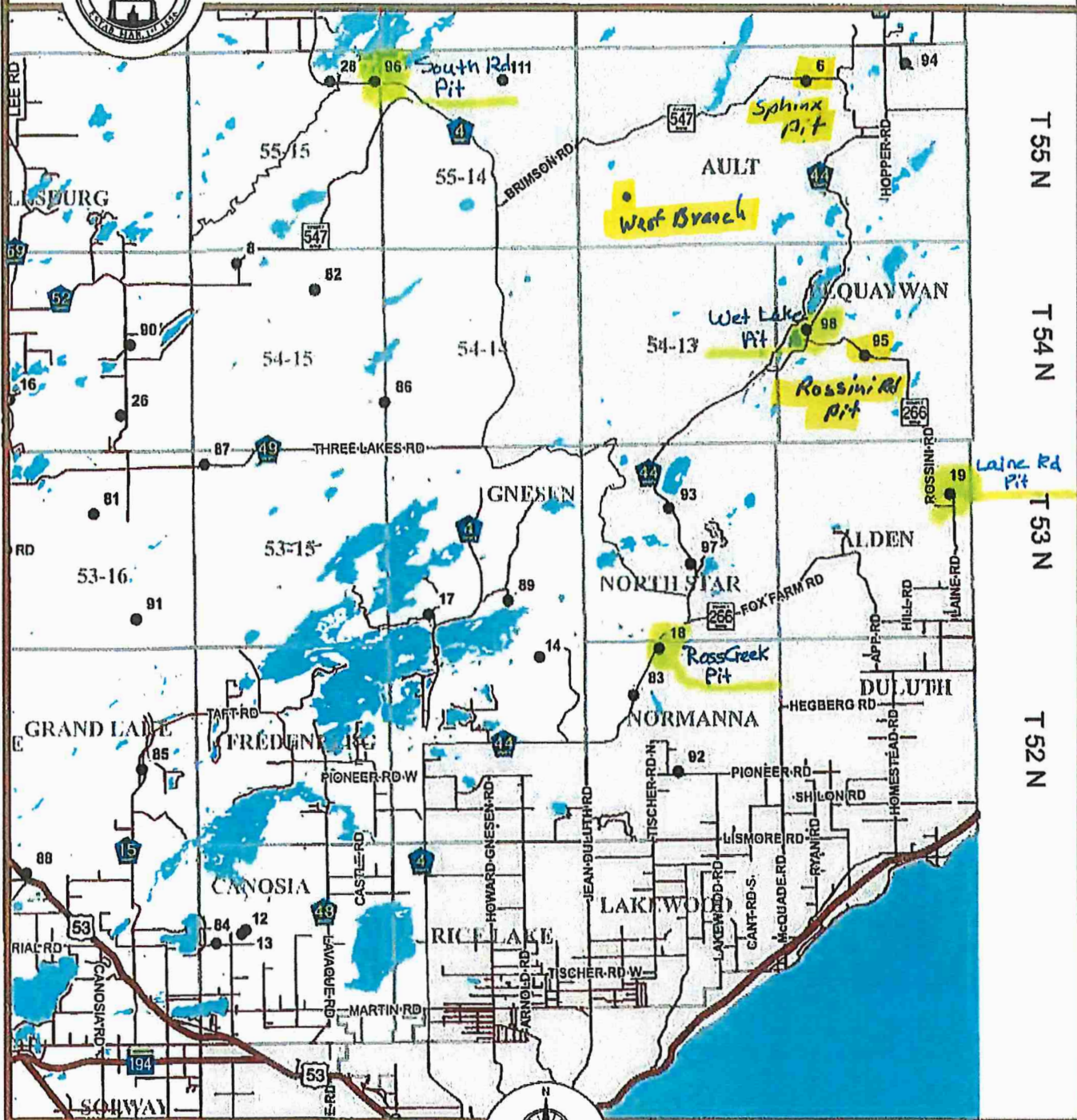

● Land Dept Gravel Pits



© Copyright Saint Louis County
All Rights Reserved

Prepared By: Land Department
Data Resource Section
(218) 725-5000
www.co.st-louis.mn.us

Map Created: 3/4/2008
Location: M:GRAVEL

Notes:

Disclaimer
This is a compilation of records as they appear in the Saint Louis County Office affecting the area shown. This drawing is to be used only for reference purposes and the County is not responsible for any inaccuracies herein contained.

Tracking #: 10.10



St. Louis County MN

