



**S A I N T
LOUIS
COUNTY**
MINNESOTA

Land and Minerals Department

Intermediate Oral Timber Auction List

August 13, 2026

11:00 A.M.

Cotton Town Hall

PLEASE NOTE:

**Pre-Registration (enclosed) for
Rounds A and B Required!**

**Decisions for sales offering the
SOAV option must be made the
day of sale when making down
payment.**

Photo Credit: Kim Seguin

**Government Services Center
320 West 2nd Street, Suite 302
Duluth, MN 55802
218-726-2606**

**Pike Lake Area Office
5713 Old Miller Trunk Highway
Duluth, MN 55811
218-625-3700**

**Virginia Area Office
7820 Highway 135
Virginia, MN 55792
218-742-9898**

stlouiscountymn.gov

NOTICE OF ST. LOUIS COUNTY PUBLIC INTERMEDIATE TIMBER AUCTION

Notice is hereby given that the St. Louis County Auditor shall sell to the highest bidder the designated timber located on the following described parcels of land forfeited to the state for the nonpayment of taxes, which have been classified and appraised as provided by Minnesota Statutes 282.04, Subd. 1(a); and that this auction may include other lands which the St. Louis County Land and Minerals Department is authorized to manage, subject, in part, to the following conditions:

1. To be eligible to bid at a St. Louis County Timber Auction, a Responsible Operator Application Form must be on file at any of our Land and Minerals Department offices at least **two (2) working days prior** to the auction. An application can be obtained at any Land and Minerals Department Office.
2. To be eligible to bid on Rounds A and/or B of a St. Louis County **Intermediate Auction**, a Registration Form must be on file with a Land and Minerals Department office at least **two (2) working days prior** to the auction. *See next page for more information on the Intermediate Auction.
3. A minimum of **15 percent** of the appraised value shall be paid immediately following the auction along with obtaining contractor signature. Fully signed contracts will be mailed to winning bidders after the auction. The remaining balance shall be paid prior to entry. **REQUIRED DOWN PAYMENT IS SPECIFIED ON LIST.**
4. Minimum bid shall be the appraised value of the sale. Bids shall be at one (1) or more percent over and above the appraised prices. The final percent bid is to be added to the price of each kind of timber advertised, unless otherwise stipulated in individual contract regulations. Species denoted as No Bid will not be subject to the percent bid increase.

**St. Louis County Land and Minerals Department does not accept cash payments.
Payment must be made by Check or Money Order.
Check must be payable to the "St Louis County Auditor"**

Sale will be held at:
Cotton Town Hall
Highway 53, Cotton, MN
11:00 A.M. - August 13, 2026

<p>Virginia Area Dave Skurla, Area Land Manager 7820 Highway 135 Virginia, MN 55792</p> <p>218-742-9898</p>	<p>Pike Lake Area Josh Carlson, Area Land Manager 5713 Old Miller Trunk Highway Duluth, MN 55811</p> <p>218-625-3700</p>
--	---

St. Louis County Intermediate Timber Auction Terms and Procedure

St. Louis County Intermediate Timber Auctions have three rounds of bidding (**Round A, Round B, Round C**). Each round has specific bidding provisions outlined below.

Round A (Tracts 1-8)

Eligible Bidders: Pre-registered businesses with a Responsible Operator Application Form on file with the St. Louis County Land and Minerals Department as outlined in item 1 under the “Notice of St. Louis County Timber Auction” and with **5 or less** employees as determined by the information submitted on the required Registration Form.

*Each business is limited to a maximum of 1 contract in Round A. Once a bidder/business is successful in receiving 1 contract, that bidder/business can no longer bid for the remainder of Round A.

*Note: Those wishing to bid on Round A of a St. Louis County Intermediate Timber Auction must pre-register by filling out and returning the Registration Form included in this booklet at least 2 working days prior to the auction.

Round B (Tracts 9-14)

Eligible Bidders: Pre-registered businesses with a Responsible Operator Application Form on file at the St. Louis County Land and Minerals Department as outlined in item 1 under the “Notice of St. Louis County Timber Auction” and with **15 or less** employees as determined by the information submitted on the required Registration Form.

*Successful bidders in Round A can also bid in Round B.

*Each business is limited to a maximum of 1 contract in Round B. Once a bidder/business is successful in receiving 1 contract, that bidder/business can no longer bid for the remainder of Round B.

*Note: Those wishing to bid on Round B of a St. Louis County Intermediate Timber Auction must pre-register by filling out and returning the Registration Form included in this booklet at least 2 working days prior to the auction.

Round C (Tracts 15-20)

Eligible Bidders: All businesses with a Responsible Operator Application Form on file at the St. Louis County Land and Minerals Department as outlined in item 1 under the “Notice of St. Louis County Timber Auction”.

*There are no requirements as to business size. Successful bidders in Round A and B can also bid in Round C.

*There is no restriction as to the number of tracts a business can purchase in Round C.

Auction Procedure

Auctioneer will offer tracts in sequential order as outlined in the auction booklet: Round A, Round B, Round C.

Upon conclusion of Round A, auctioneer will immediately begin Round B and offer tracts in sequential order as outlined in auction booklet. Any tracts remaining unbid from Round A will be offered at the end of Round B. Any tracts remaining unbid from Round A and B will be offered at the end of Round C.

Please Note:

Forest products offered are certified to the Sustainable Forestry Initiative (SFI®) Standard according to the Land and Minerals Department's SFI® certificate unless otherwise indicated in the "Comments" section for the tract and corresponding contract document.

Many of the tracts have special requirements. The St. Louis County Land and Minerals Department offers sales of various sizes, species, and products to meet the needs of a wide variety of purchasers.

There are some sales offered on this auction that allow the purchaser to decide if they want to purchase the sale as offered, or choose to have all the species sold as SOAV. These are identified with the following sentence in the comments of each tract: "The purchaser has the option to purchase this sale as advertised or to purchase all species as Sold On Appraised Volume (SOAV)". SOAV species are intended to include the entire above ground portion of the tree, including residuals and may be removed at the discretion of the contractor, unless otherwise specified. Roundwood measure is shown for bidding purposes only, and does not include any estimate of residuals. SOAV species are to be sold based on the appraisal without scaling.

Producing biomass from merchantable roundwood of scaled species may be allowed if consumer scaling requirements are met. Please contact the Sale Administrator for more information on this process.

Timber products are sold by species. Purchasers are encouraged to evaluate sales to determine the specific products available from the sold species.

If there is any conflict between the Timber Sale Package and this advertisement, the Timber Sale Package is the controlling document. The Timber Sale Package contains maps, volume and values, contract information and harvest provisions, and is available at the applicable AREA OFFICE listed on the previous page or on the county website:

STLOUISCOUNTYMN.GOV

Successful bidders pay down payment and submit signature immediately following the auction. For contracts offering the option of choosing Sold On Appraised Volume (SOAV), successful bidders must elect to choose this option when paying the down payment pursuant to Minnesota Statute 90.14.

Successful bidders using a Letter of Credit to secure the purchase of a sale will have ten (10) business days to provide the Letter of Credit to the Land and Minerals Department. A \$300 bid bond, i.e. personal check, payable to the St. Louis County Auditor is required and must be paid the day of the auction. One bid bond will cover all purchased tracts that will be secured by Letter of Credit.

Optional Products are products that can be purchased prior to the entire sale payment or when a block payment is to be made. These products will not be included into the 15% downpayment of the appraised value and will not be factored into the bid value. Optional products advertised will be noted in the Sales Comments and will be listed separately under the species volume/value information.

Timber Sale Operators must have the following minimum training for at least the owner of the firm and the foreman who will supervise the logging on St. Louis County Tax Managed Lands:

- Master Logging Certification; or
- Minnesota Logger Education (MLEP) Member in Good Standing; or SFI Training FISTA member: or
- Training equivalent to the Minnesota SFI Implementation Committee Training Standard for a trained Professional Logger.

All field employees must have training in best management practices.

Published as follows is the list of timber to be offered at public auction sale as announced and advertised in the official newspaper within this county.

Round A

Tracts 1-8



St. Louis County August 13, 2026 Timber Auction

Tract #: 1

C26-631904

Sale Administrator: Christopher Lintula

Virginia Area
C19260063

Total Appraised: \$20,664.65
Down Payment Required: \$3,099.70
Expires: 4/15/2030

Twp. 63N Rge. 19W Sec. 4

Total Acres: 33.6

47° 58.424' N 092° 46.372' W

Blocks: 1

Species	Sticks	Dia.
Aspen	5.2	11.3
Balsam Fir	1.3	5.5
Maple-Red	2.6	8.5
Birch	3.5	9.5
Balm Of Gilead	3.0	14.0

Comments:

-There is an outbreak of Spruce budworm infecting balsam fir on this sale. Only currently live trees were cruised.

Block	Operational Periods
1	Dry soil after August 1 or Frozen Ground

Products	No Bid	Total Volume	Appraised Value	Total Value
Total for Blocks 1				
Aspen		813 Cords @	\$24.11 =	\$19,601.43
Balm Of Gilead		2 Cords @	\$24.11 =	\$48.22
Balsam Fir	X	130 Cords @	\$5.00 =	\$650.00
SOAV Birch	X	11 Cords @	\$5.00 =	\$55.00
SOAV Maple-Red	X	62 Cords @	\$5.00 =	\$310.00
Total Appraised Value:				\$20,664.65

C19260063

St. Louis County
C26-631904

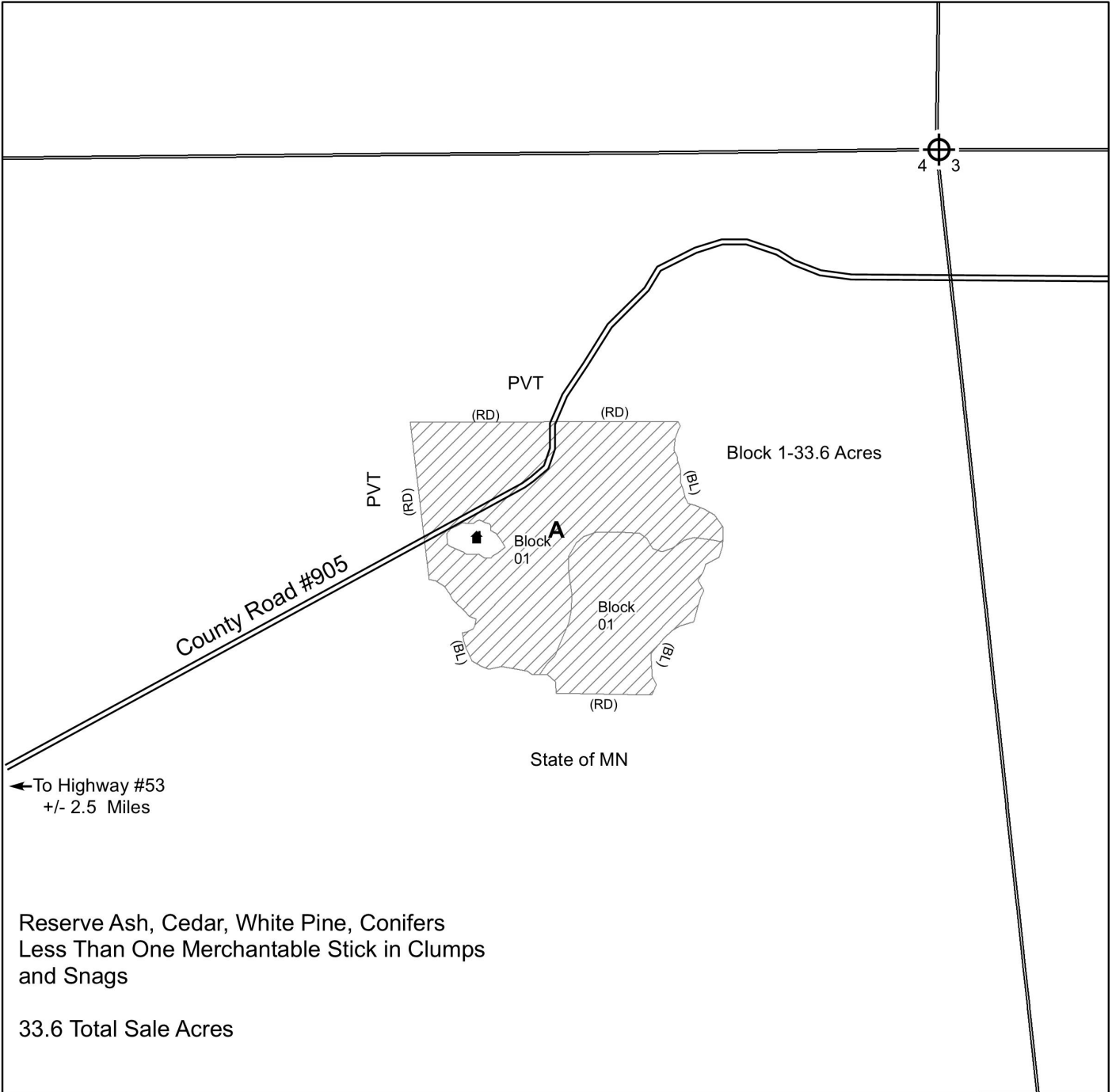





← To Highway #53
+/- 2.5 Miles

Reserve Ash, Cedar, White Pine, Conifers
Less Than One Merchantable Stick in Clumps
and Snags

33.6 Total Sale Acres

Prepared By: Chris Lintula
 Map Created: 5/14/2026
 TRS: Twp. 63N. Rge. 19W. Sec. 4
 Disclaimer:
 This is a compilation of records as they appear in the Saint Louis County Offices affecting the area shown. This drawing is to be used only for reference purposes and the County is not responsible for any inaccuracies herein contained.

1 in = 0.125 miles
 0 0.25 Miles

- (BL) (RD)  -Harvest Area-CCT-Boundary Painted Blue or Red
- (DB)  -Reserve Area-Boundary Painted Double Blue
-  -Gravel Road
-  -Lease Cabin

- A -Aspen Covertypes
-  -Section Corner

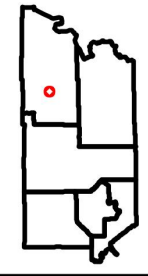



St. Louis County August 13, 2026 Timber Auction

Tract #: 2

C26-641720

Sale Administrator: Casey Anderson

Virginia Area
C19260066

Total Appraised: \$2,140.00

Twp. 64N Rge. 17W Sec. 19, 20

Total Acres: 44.7

Down Payment Required: \$321.00

Expires: 4/15/2030

48° 0.571' N 092° 32.783' W

Blocks: 1

Species	Sticks	Dia.
Pine-Norway	3.3	9.2
Pine-Jack	2.3	6.8
Aspen	3.2	8.8
Balsam Fir	2.5	6.5
Birch	1.8	6.4
Pine-White	3.1	10.3

Comments:

- This sale includes a self-directed thinning. 15-foot-wide skid trails will be cut with 40-foot-wide leave strips. Harvesting and skidding equipment width must not exceed 12 feet.
- There is an outbreak of Spruce budworm infecting Balsam Fir, Spruce, Jack Pine species on this sale. Only currently live trees were cruised.
- Rock outcrops are present throughout the sale area.

Block	Operational Periods
1	Dry soil from September 1 to April 30, operation period may be adjusted with permission, see harvest provisions

Products	No Bid	Total Volume	Appraised Value	Total Value
Total for Blocks 1				
Aspen	X	10 Cords @	\$5.00 =	\$50.00
Balsam Fir	X	5 Cords @	\$5.00 =	\$25.00
SOAV Birch	X	1 Cords @	\$5.00 =	\$5.00
SOAV Maple-Red	X	1 Cords @	\$5.00 =	\$5.00
Pine-Jack		20 Cords @	\$5.00 =	\$100.00
Pine-Norway		388 Cords @	\$5.00 =	\$1,940.00
Pine-White		1 Cords @	\$5.00 =	\$5.00
Spruce-Black	X	1 Cords @	\$5.00 =	\$5.00
Spruce-White	X	1 Cords @	\$5.00 =	\$5.00
Total Appraised Value:				\$2,140.00

C19260066

St. Louis County

C26-641720

+/- 3.5 miles to County rd 24 via South Eicholz rd →

1. Remove all species within a maximum allowed 15' wide skid trails within the thinning area.
2. Retain a minimum 40' wide thinning strip between the skid trails.
3. In the thinning strip remove trees to a Basal Area (BA) of 100 BA.

First remove contract species, except Red Pine, to meet spacing requirements.

Second Remove Red Pine with smaller diameters or poor form (forks, crook, double tops, sweep, etc.) to meet spacing requirements.

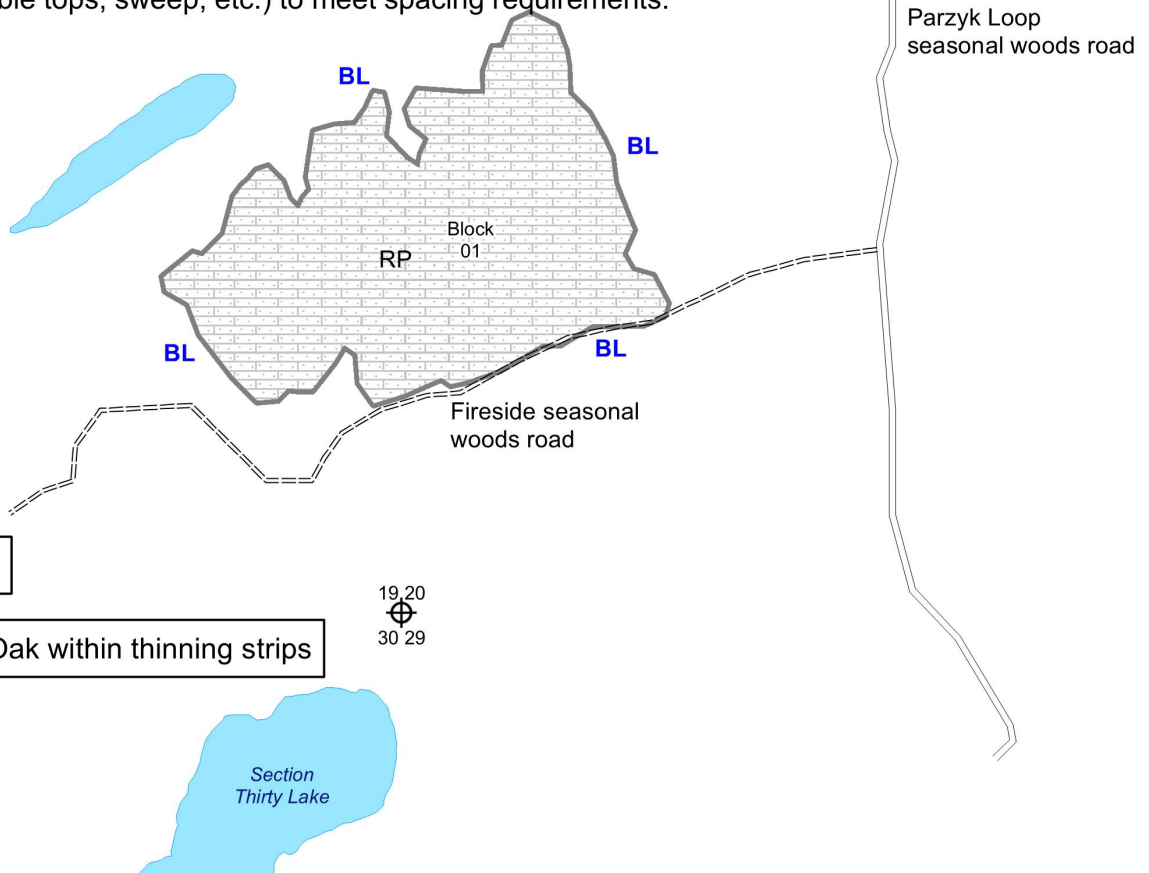

Sale Acres: 44.7

Reserve all: Red Oak within thinning strips

Prepared By: Casey Anderson

Map Created: 4/24/2026

TRS: 641720

Disclaimer:
This is a compilation of records as they appear in the Saint Louis County Offices affecting the area shown. This drawing is to be used only for reference purposes and the County is not responsible for any inaccuracies herein contained.

0 0.1 0.2 Miles

SDT- Harvest area

RP Red Pine

BL Painted Blue Line

Section Corner

----- Seasonal Woods Road Spur/Designated Atv trail

===== Seasonal Woods Road/Designated Atv trail

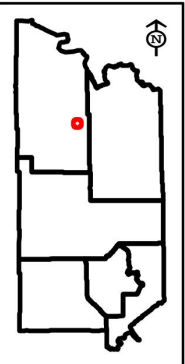



St. Louis County August 13, 2026 Timber Auction

Tract #: 3	C26-641903	Sale Administrator: Hayden Pocquette
Virginia Area C19260067	Total Appraised: \$16,869.50	Twp. 64N Rge. 19W Sec. 3 and Twp. 65N Rge. 19W Sec. 35
Total Acres: 25.3	Down Payment Required: \$2,530.43	
Blocks: 1	Expires: 4/15/2029	48° 3.799' N 092° 44.707' W

Species	Sticks	Dia.
Aspen	4.4	7.7
Maple-Red	1.8	6.4
Balsam Fir	2.5	6.5

Comments:

- A minimum \$2000.00 of the downpayment will be retained and will be held until the satisfactory completion of the contract.
 -Frozen Ground conditions due to guaranteed access. If an alternate access is obtained, operations during Dry Soil conditions may be allowed at Sellers discretion.

Access:

Access secured through private

Block	Operational Periods
1	Frozen Ground

Products		No Bid	Total Volume	Appraised Value	Total Value
Total for Blocks 1					
	Aspen		773 Cords @	\$21.70 =	\$16,774.10
SOAV	Balsam Fir	X	4 Cords @	\$5.10 =	\$20.40
SOAV	Maple-Red	X	15 Cords @	\$5.00 =	\$75.00
Total Appraised Value:					\$16,869.50

C19260067

St. Louis County

C26-641903

Reserve: Oak, conifers less than one merchantable stick in clumps, and snags

Total Sale Acres: 25.3

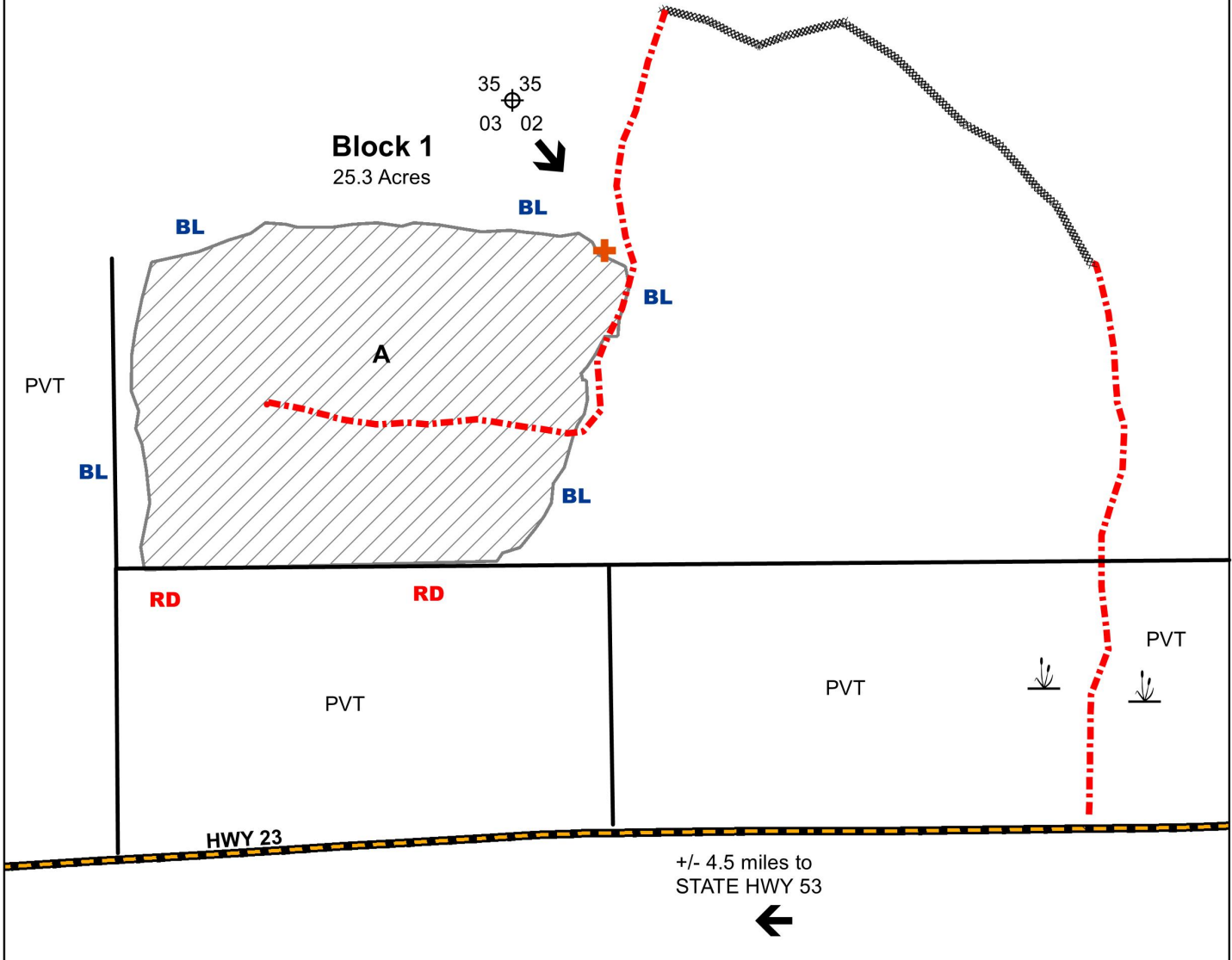

Prepared By: Hayden Pocquette

Map Created: 04/21/2026

TRS: T.64 R.19 Sec.03

Disclaimer:

This is a compilation of records as they appear in the Saint Louis County Offices affecting the area shown. This drawing is to be used only for reference purposes and the County is not responsible for any inaccuracies herein contained.

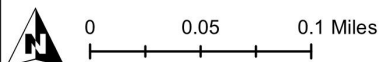

PVT Private

A Aspen

⊕ Section Corner

Harvest Area - CCT - Boundary Marked **BL RD**

Designated Winter Road - Existing

Designated Winter Road - New Construction

Wetland or Marsh

Survey Marker - Protect

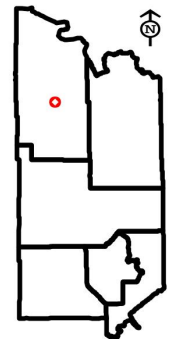



St. Louis County August 13, 2026 Timber Auction

Tract #: 4

V26-581818

Sale Administrator: Kyle Andrews

Virginia Area
C19260073

Total Appraised: \$10,480.67
Down Payment Required: \$1,572.10
Expires: 4/15/2029

Twp. 58N Rge. 18W Sec. 18

Total Acres: 29.6

47° 30.406' N 092° 41.115' W

Blocks: 1

Species	Sticks	Dia.
Aspen	5.3	11.4
Maple-Red	3.4	8.8
Spruce-White	5.7	13.6
Ash	3.5	6.9
Birch	3.9	8.8
Balsam Fir	3.6	8.3

Comments:

- A minimum \$2000.00 of the downpayment will be retained and will be held until the satisfactory completion of the contract.
- This sale does not meet our cruising error standards. Please talk to the Sale Administrator for more information.
- This sale is in the Emerald Ash Borer Quarantine Area.

Operational Periods:

Frozen Ground

Block	Operational Periods
1	Frozen Ground

Products		No Bid	Total Volume	Appraised Value	Total Value
Total for Blocks 1					
SOAV	Ash	X	38 Cords @	\$5.00 =	\$190.00
	Aspen		483 Cords @	\$19.29 =	\$9,317.07
	Balsam Fir	X	19 Cords @	\$5.00 =	\$95.00
SOAV	Birch	X	26 Cords @	\$5.00 =	\$130.00
SOAV	Maple-Red	X	65 Cords @	\$5.00 =	\$325.00
	Spruce-White	X	40 Cords @	\$10.59 =	\$423.60
Total Appraised Value:					\$10,480.67

C19260073

St. Louis County
V26-581818

Block 1a - 27.8 Ac.
Block 1b - 0.4 Ac.
Block 1c - 1.4 Ac.

Total Acres = 29.6

Reserve all: Snags

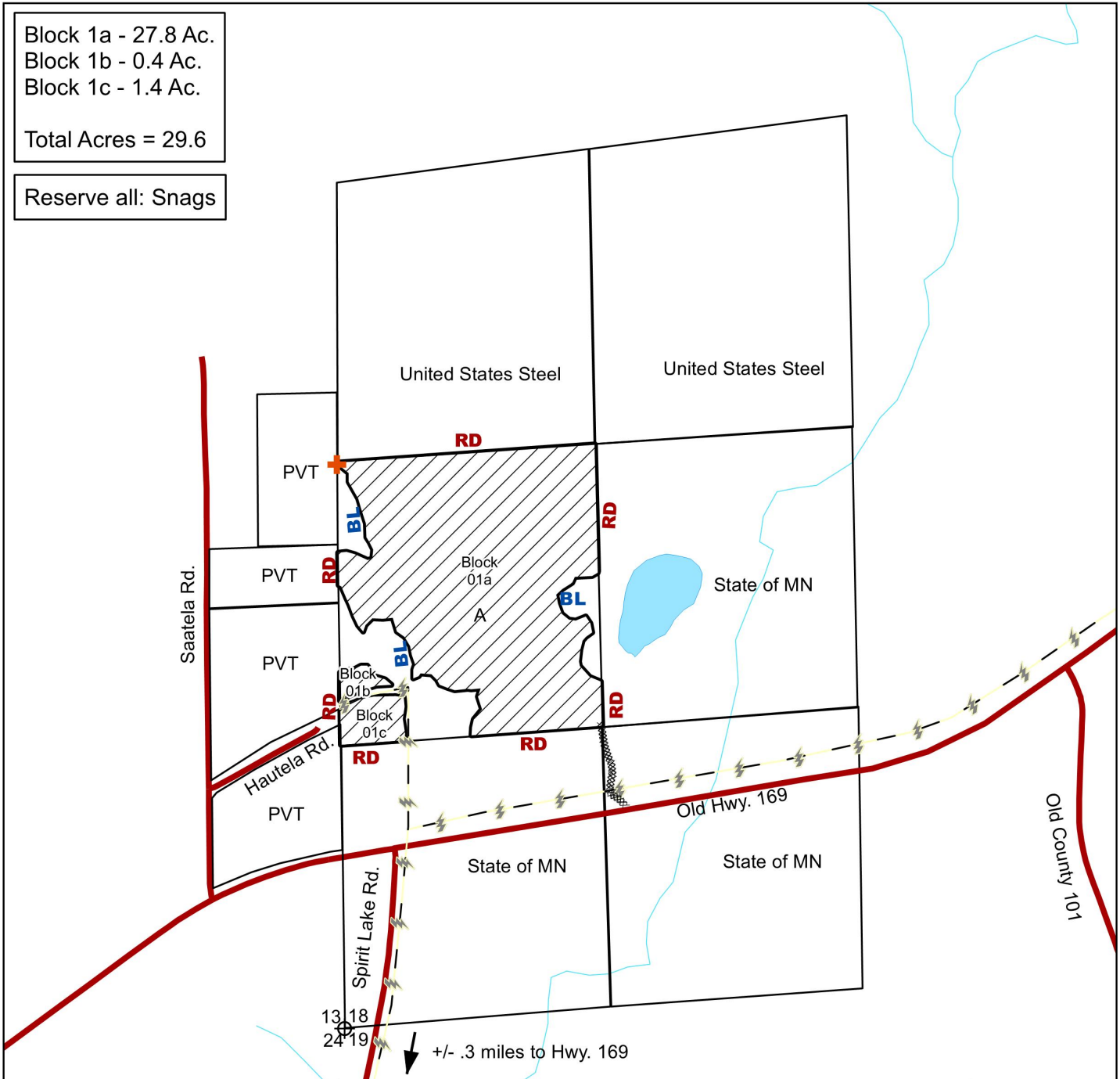

Prepared
By: Kyle Andrews

Map Created: 4/30/26

TRS: 58-18-18

Disclaimer:

This is a compilation of records as they appear in the Saint Louis County Offices affecting the area shown. This drawing is to be used only for reference purposes and the County is not responsible for any inaccuracies herein contained.

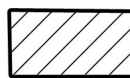
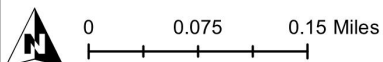

- CCT (Clearcut)

BL - Blue Painted Boundary Line

RD - Red Painted Boundary Line

+ - Survey Marker (Protect)

- Section Corner

PVT - Private

A - Aspen

- Powerline

- Designated Access Road
(New Construction)

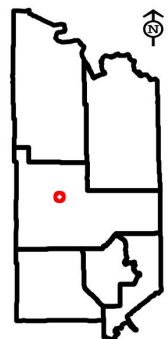



St. Louis County August 13, 2026 Timber Auction

Tract #: 5

B26-551212

Sale Administrator: Robert Benson

Pike Lake Area
C19260077

Total Appraised: \$17,848.75

Twp. 55N Rge. 12W Sec. 12

Total Acres: 65.6

Down Payment Required: \$2,677.31

Expires: 4/15/2030

47° 15.782' N 091° 48.203' W

Blocks: 1

Species	Sticks	Dia.
Spruce-White	3.7	9.1
Aspen	3.3	7.7
Balm Of Gilead	2.0	6.0

Comments:

-The purchaser has the option to purchase this sale as advertised or to purchase all species as Sold On Appraised Volume (SOAV). Optional Products will be included with the SOAV option if advertised.

-There is an outbreak of Spruce budworm infecting white spruce species on this sale. Only currently live trees were cruised.

-This sale is in the Emerald Ash Borer Quarantine Area.

Access:

Access to the sale area is via Rollins Road and uses the existing unimproved road known as Wolf Attack Seasonal Woods Road to enter into the sale area.

Operational Periods:

Dry soil after June 1 or Frozen Ground

Block	Operational Periods
1	Dry soil after June 1 or Frozen Ground

Products	No Bid	Total Volume	Appraised Value	Total Value
Total for Blocks 1				
Aspen	X	30 Cords @	\$24.11 =	\$723.30
Balm Of Gilead	X	3 Cords @	\$24.11 =	\$72.33
Spruce-White		1288 Cords @	\$13.24 =	\$17,053.12
Total Appraised Value:				\$17,848.75

C19260077

St. Louis County

B26-551212

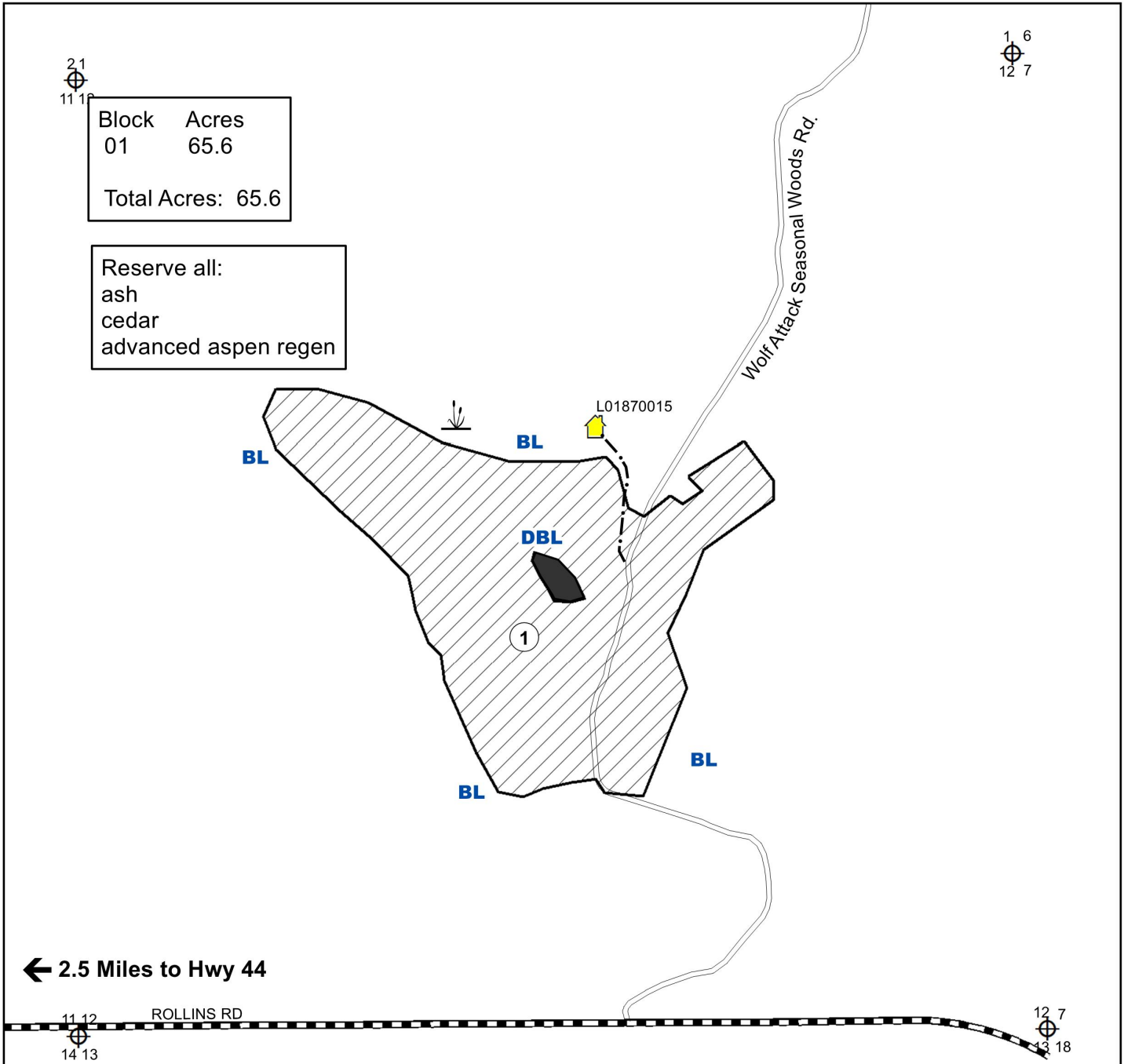

Block	Acres
01	65.6
Total Acres: 65.6	

Reserve all:
ash
cedar
advanced aspen regen

← 2.5 Miles to Hwy 44

Prepared By: **Robert Benson**

Map Created: 4/15/2026

TRS: 551212

Disclaimer:
This is a compilation of records as they appear in the Saint Louis County Offices affecting the area shown. This drawing is to be used only for reference purposes and the County is not responsible for any inaccuracies herein contained.

0 0.1 0.2 Miles

- Clearcut
- Cabin Leases
- Pavement Road
- Painted Blue Line
- Reserve Area
- Wetland or Marsh
- Section Corner
- Painted Double Blue Line
- Lease Access

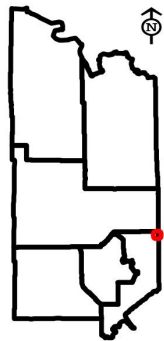



St. Louis County August 13, 2026 Timber Auction

Tract #: 6

F26-501708

Sale Administrator: Daniel Preiner

Pike Lake Area
C19260078

Total Appraised: \$8,854.84

Twp. 50N Rge. 17W Sec. 6, 8, 17

Down Payment Required: \$1,328.23

Total Acres: 62.4

Expires: 4/15/2030

46° 49.718' N 092° 31.181' W

Blocks: 2

Species	Sticks	Dia.
Pine-Norway	5.5	12.8
Birch	4.3	10.9
Maple-Sugar	3.0	8.7
Basswood	5.1	11.8
Maple-Red	3.1	9.7
Ash	3.6	9.0

Comments:

-Operations on this sale will be required to use GPS technology to determine the location of unpainted boundaries. See harvest provisions or contact the sale administrator for details.

Access:

The sale is accessed of the Heritage FMR. Block 1a is 0.3 miles in off of US HWY 2. Block 2a is 1.8 miles in off of US HWY 2. Any spur road coming off of the Heritage FMR that is utilized for this sale will have to be bermed prior to sale close out.

Operational Periods:

Pine harvesting in Block 1a must occur during Dry soil from September 1 to April 30, operation may be adjusted with permission, see harvest provisions.

Block	Operational Periods
1	Dry soil after June 1 or Frozen Ground
2	Frozen Ground

Products	No Bid	Total Volume	Appraised Value	Total Value
Total for Blocks 1, 2				
SOAV Ash		119 Cords @	\$5.00 =	\$595.00
Aspen		45 Cords @	\$24.11 =	\$1,084.95
Balm Of Gilead		18 Cords @	\$24.11 =	\$433.98
SOAV Basswood		276 Cords @	\$5.49 =	\$1,515.24
Birch		351 Cords @	\$5.55 =	\$1,948.05
SOAV Maple-Red		141 Cords @	\$5.00 =	\$705.00
SOAV Maple-Sugar		367 Cords @	\$5.54 =	\$2,033.18
Pine-Norway		22 Cords @	\$24.52 =	\$539.44
Total Appraised Value:				\$8,854.84

Volume Per Block	Block 1	Block 2
Ash pulpwood	19	100
Aspen pulpwood	16	29
Balm Of Gilead pulpwood		18
Basswood pulpwood	219	57
Birch pulpwood	248	103
Maple-Red pulpwood	11	130
Maple-Sugar pulpwood	299	68
Pine-Norway pulpwood	22	

C19260078

St. Louis County

F26-501708

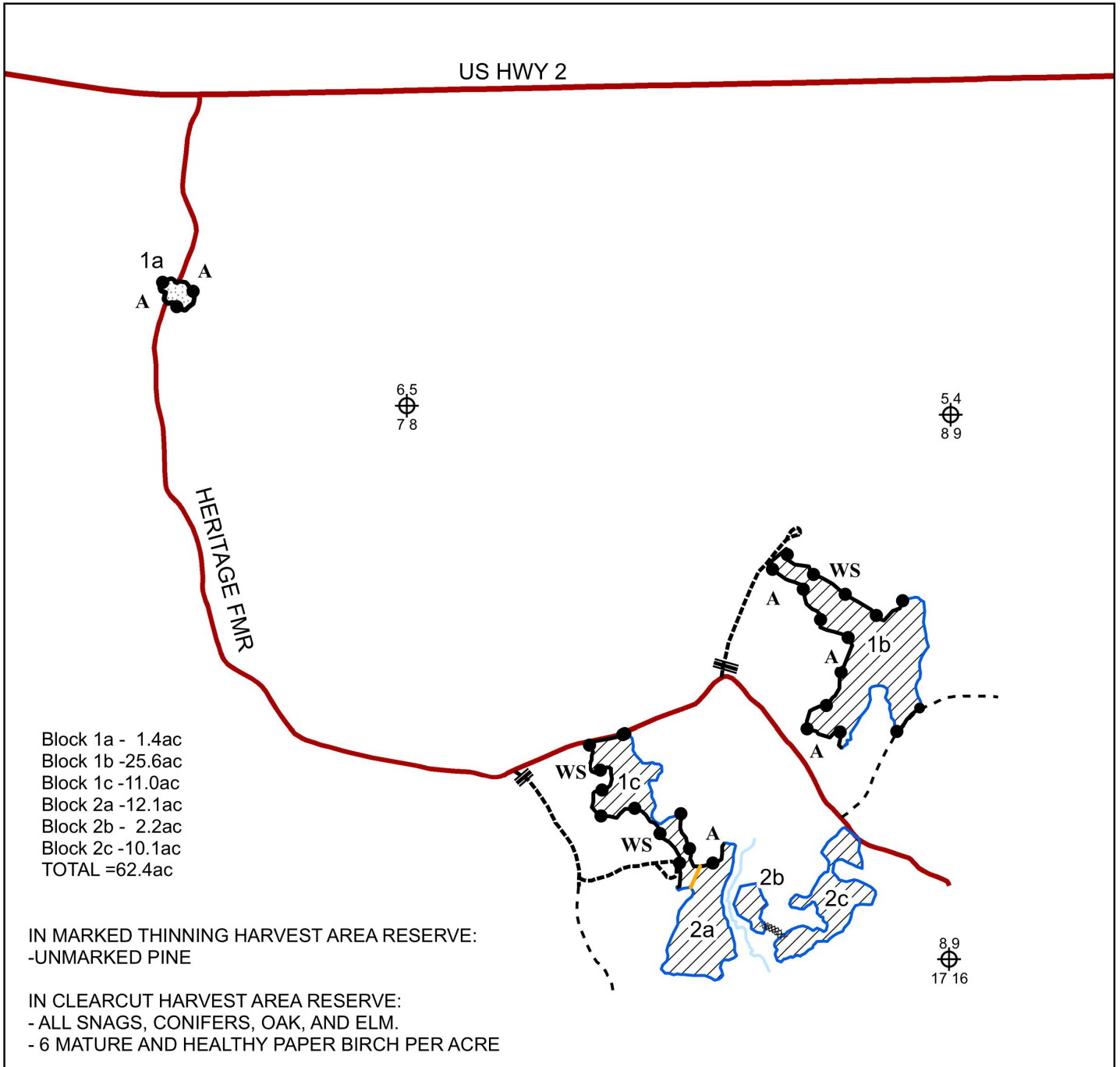

Prepared By: Dan Preiner
 Map Created: 4/27/2026
 TRS: T50N-R17W sec 8

Disclaimer:
 This is a compilation of records as they appear in the Saint Louis County Offices affecting the area shown. This drawing is to be used only for reference purposes and the County is not responsible for any inaccuracies herein contained.

0 55 110 Miles

- HARVEST AREA CLEARCUT
- HARVEST MARKED THINNING
- PAINTED BLUE LINE
- UNPAINTED BOUDARY
- UNPAINTED BLOCK LINE
- SECTION CORNER
- SPRUCE PLANTATION
- ASPEN REGEN
- PERENNIAL STREAM
- SEASONAL WOODS RD
- WINTER RD
- NEW CONSTRUCTION
- BERM

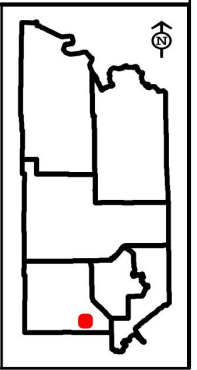



St. Louis County August 13, 2026 Timber Auction

Tract #: 7

F26-532020

Sale Administrator: Drake Schroeder

Pike Lake Area
C19260079

Total Appraised: \$41,232.05

Twp. 53N Rge. 20W Sec. 20, 21, 28, 29

Total Acres: 59.4

Down Payment Required: \$6,184.81

Expires: 4/15/2029

47° 3.398' N 092° 53.692' W

Blocks: 2

Species	Sticks	Dia.
Aspen	5.8	11.5
Ash	3.7	9.4
Balsam Fir	3.4	8.9
Maple-Red	3.4	11.0
Birch	4.0	10.0
Balm Of Gilead	5.0	9.4

Comments:

- Operations on this sale will be required to use GPS technology to determine the location of unpainted boundaries. See harvest provisions or contact the sale administrator for details.
- Roundwood chipping of scaled species will be allowed if scaling requirements are met.
- This sale is in the Emerald Ash Borer Quarantine Area.

Block	Operational Periods
1, 2	Frozen Ground

Products	No Bid	Total Volume	Appraised Value	Total Value
Total for Blocks 1, 2				
SOAV Ash		369 Cords @	\$5.50 =	\$2,029.50
Aspen		1395 Cords @	\$26.52 =	\$36,995.40
Balm Of Gilead		28 Cords @	\$26.52 =	\$742.56
Balsam Fir		44 Cords @	\$6.23 =	\$274.12
SOAV Birch		23 Cords @	\$6.11 =	\$140.53
SOAV Maple-Red		144 Cords @	\$5.50 =	\$792.00
SOAV Maple-Sugar		10 Cords @	\$6.09 =	\$60.90
SOAV Spruce-Black		12 Cords @	\$9.14 =	\$109.68
SOAV Spruce-White		6 Cords @	\$14.56 =	\$87.36
Total Appraised Value:				\$41,232.05

Volume Per Block	Block 1	Block 2
Ash pulpwood	193	176
Aspen pulpwood	889	506
Balm Of Gilead pulpwood	6	22
Balsam Fir pulpwood		44
Birch pulpwood	15	8
Maple-Red pulpwood	107	37
Maple-Sugar pulpwood	10	
Spruce-Black pulpwood	9	3
Spruce-White pulpwood	3	3

C19260079

St. Louis County

F26-532020

Reserve all:
Balsam Fir (Blocks 1 and 2a)
Basswood
Burr Oak
Cedar
Elm
Snags

Block	Acres
01	28.9
02a	14.9
02b	13.8
02c	1.8
Total Acres: 59.4	

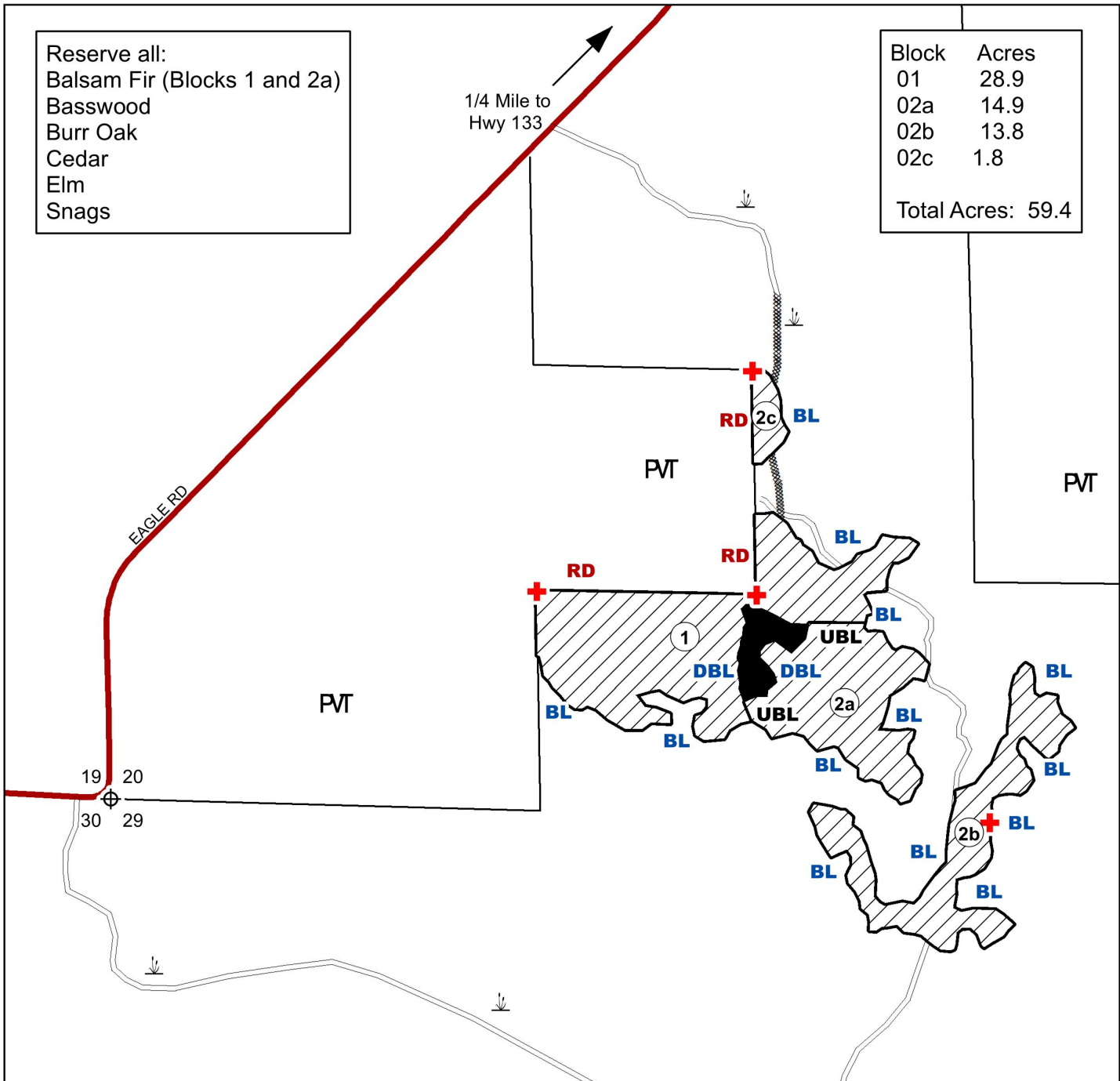

Prepared By: Steven Boberg and Drake Schroeder
Map Created: 5/5/2026
TRS: 532020
Disclaimer:
This is a compilation of records as they appear in the Saint Louis County Offices affecting the area shown. This drawing is to be used only for reference purposes and the County is not responsible for any inaccuracies herein contained.

- Clearcut
- Proposed Road / New Construction
- BL Painted Blue Line
- RD Painted Red Line
- DBL Painted Double Blue Line
- Reserve Area
- Seasonal Woods Road
- Wetland or Marsh
- PVT Private
- Survey Marker (protect)
- UBL Unpainted Block Line

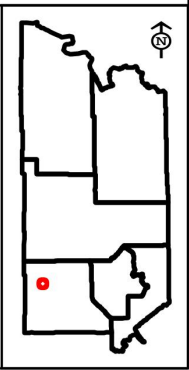



St. Louis County August 13, 2026 Timber Auction

Tract #: 8	K26-541506	Sale Administrator: Erik Anton
Pike Lake Area C19260082	Total Appraised: \$38,652.11	Twp. 54N Rge. 15W Sec. 5, 6, 7 and Twp. 54N Rge. 16W
Total Acres: 114.3	Down Payment Required: \$5,797.82	Sec. 12
Blocks: 6	Expires: 4/15/2030	47° 11.06' N 092° 17.472' W

Species	Sticks	Dia.
Aspen	4.2	10.9
Balsam Fir	2.7	9.9
Birch	3.1	9.0
Spruce-White	4.3	13.1
Balm Of Gilead	3.0	8.4
Spruce-Black	2.7	8.4

Comments:

- The purchaser has the option to purchase this sale as advertised or to purchase all species as Sold On Appraised Volume (SOAV). Optional Products will be included with the SOAV option if advertised.
- Operations on this sale will be required to use GPS technology to determine the location of unpainted boundaries. See harvest provisions or contact the sale administrator for details.
- Roundwood chipping of scaled species will be allowed if scaling requirements are met.
- This sale is in the Emerald Ash Borer Quarantine Area.
- The harvest area involves operating near a commercial tower, guide wires, and some fencing (see provision 100.0.1).

Access:

Sale access will be primarily off the Comstock Lake Road. Three driveways for blocks 2, 3, 4, and 6 will need to be constructed following driveway permit directives which may include culvert installation. Prior to sale closure, berms will need to be constructed at sellers' discretion on newly constructed driveways.

Block	Operational Periods
1, 5	Frozen Ground
2, 3, 6	Dry soil after June 1 or Frozen Ground
4	Dry soil after July 1 or Frozen Ground

Products	No Bid	Total Volume	Appraised Value	Total Value
Total for Blocks 1, 2, 3, 4, 5, 6				
Aspen		1696 Cords @	\$21.70 =	\$36,803.20
Balm Of Gilead		9 Cords @	\$21.70 =	\$195.30
Balsam Fir		153 Cords @	\$7.07 =	\$1,081.71
SOAV Birch		53 Cords @	\$5.00 =	\$265.00
SOAV Spruce-Black		6 Cords @	\$7.48 =	\$44.88
SOAV Spruce-White		22 Cords @	\$11.91 =	\$262.02
Total Appraised Value:				\$38,652.11

Volume Per Block	Block 1	Block 2	Block 3	Block 4	Block 5	Block 6
Aspen pulpwood	259	188	253	355	420	221
Balm Of Gilead pulpwood					4	5
Balsam Fir pulpwood	3	24	33	25	45	23
Birch pulpwood		14	19	3	10	7
Spruce-Black pulpwood		1	1			4
Spruce-White pulpwood					2	20

C19260082

St. Louis County

K26-541506

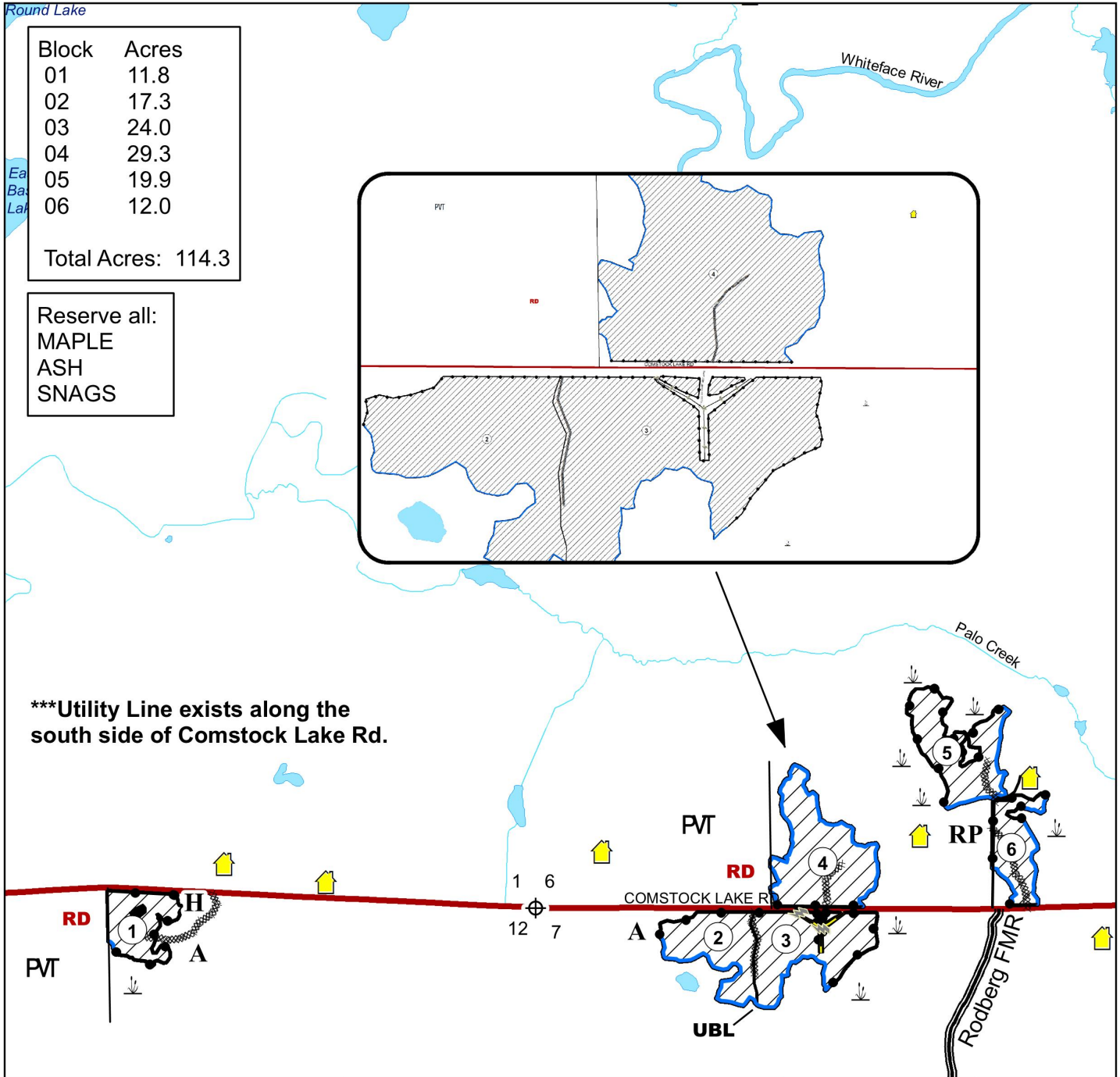

Prepared By: Erik Anton Map Created: 4/27/2026 TRS: 541612 Disclaimer: This is a compilation of records as they appear in the Saint Louis County Offices affecting the area shown. This drawing is to be used only for reference purposes and the County is not responsible for any inaccuracies herein contained.	<table style="width: 100%; border: none;"> <tr> <td style="width: 30px;"></td> <td>Clearcut</td> <td style="width: 30px;">A</td> <td>Aspen</td> <td style="width: 30px;">H</td> <td>Ash</td> <td style="width: 30px;">RP</td> <td>Red Pine</td> </tr> <tr> <td></td> <td>Cabin Leases</td> <td></td> <td></td> <td></td> <td></td> <td>PVT</td> <td>Private</td> </tr> <tr> <td></td> <td>Reserve Areas (Painted Double Blue Line)</td> <td></td> <td></td> <td></td> <td></td> <td>RD</td> <td>Painted Red Line</td> </tr> <tr> <td></td> <td>Powerline</td> <td></td> <td></td> <td></td> <td></td> <td>—</td> <td>Lease Access</td> </tr> <tr> <td></td> <td>Designated Access Road</td> <td></td> <td></td> <td></td> <td></td> <td>UBL</td> <td>Unpainted Block Line</td> </tr> <tr> <td></td> <td>Unpainted Boundary</td> <td></td> <td></td> <td></td> <td></td> <td>⊕</td> <td>Section Corner</td> </tr> <tr> <td></td> <td>Painted Blue Line</td> <td></td> <td></td> <td></td> <td></td> <td></td> <td></td> </tr> </table>		Clearcut	A	Aspen	H	Ash	RP	Red Pine		Cabin Leases					PVT	Private		Reserve Areas (Painted Double Blue Line)					RD	Painted Red Line		Powerline					—	Lease Access		Designated Access Road					UBL	Unpainted Block Line		Unpainted Boundary					⊕	Section Corner		Painted Blue Line							
	Clearcut	A	Aspen	H	Ash	RP	Red Pine																																																			
	Cabin Leases					PVT	Private																																																			
	Reserve Areas (Painted Double Blue Line)					RD	Painted Red Line																																																			
	Powerline					—	Lease Access																																																			
	Designated Access Road					UBL	Unpainted Block Line																																																			
	Unpainted Boundary					⊕	Section Corner																																																			
	Painted Blue Line																																																									

This page intentionally left blank.

Round B

Tracts 9-14



St. Louis County August 13, 2026 Timber Auction

Tract #: 9	C26-632132	Sale Administrator: Shontel Adam	
Virginia Area	Total Appraised: \$20,612.14		Twp. 63N Rge. 21W Sec. 32
C19260065	Down Payment Required: \$3,091.82		47° 53.828' N 093° 3.35' W
Total Acres: 30	Expires: 4/15/2029		
Blocks: 1			

Species	Sticks	Dia.
Aspen	4.4	8.3
Balm Of Gilead	3.1	7.0
Birch	1.7	5.7

Comments:

Block	Operational Periods
1	Frozen Ground

Products		No Bid	Total Volume	Appraised Value	Total Value
Total for Blocks 1					
	Aspen		828 Cords @	\$24.11 =	\$19,963.08
	Balm Of Gilead		26 Cords @	\$24.11 =	\$626.86
SOAV	Birch	X	4 Cords @	\$5.55 =	\$22.20
Total Appraised Value:					\$20,612.14

C19260065

St. Louis County
C26-632132

RESERVE ELM, ASH, BALSAM FIR, WHITE SPRUCE, AND SNAGS
CONIFERS LESS THAN 1 STICK ARE TO BE RESERVED IN CLUMPS

TOTAL ACRES= 30

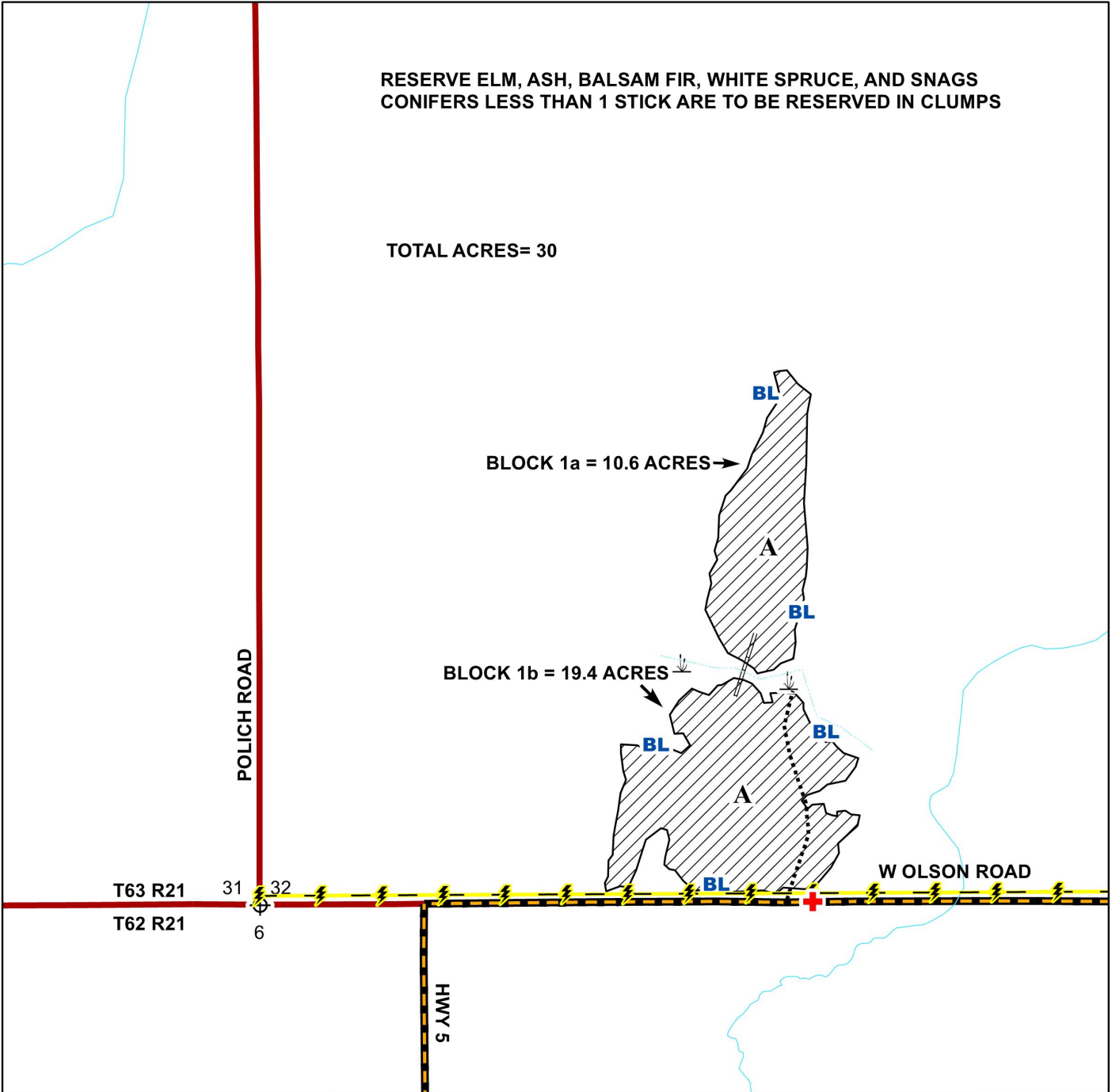

Prepared By: SHONTEL ADAM
Map Created: 5/18/2026
TRS: 632132
Disclaimer:
This is a compilation of records as they appear in the Saint Louis County Offices affecting the area shown. This drawing is to be used only for reference purposes and the County is not responsible for any inaccuracies herein contained.

1 in = 0.125 miles
0 0.25 Miles

- HARVEST AREA CLEARCUT-CCT-BOUNDARIES PAINTED BLUE
- ASPEN COVERTYPE
- EXISTING WINTER ROAD
- PROPOSED ACCESS-(NEW WINTER CONSTRUCTION)
- WETLAND
- POWERLINE
- SECTION CORNER
- INTERMITTENET STREAM
- SURVEY MARKER

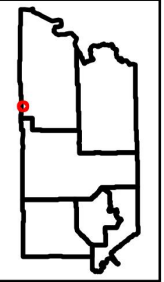



St. Louis County August 13, 2026 Timber Auction

Tract #: 10

C26-651720

Sale Administrator: Casey Anderson

Virginia Area
C19260068

Total Appraised: \$22,212.24

Twp. 65N Rge. 17W Sec. 19, 20, 29, 30

Down Payment Required: \$3,331.84

Total Acres: 42.7

Expires: 4/15/2030

48° 5.501' N 092° 33.404' W

Blocks: 1

Species	Sticks	Dia.
Aspen	4.0	9.7
Pine-Norway	4.0	8.9
Pine-Jack	4.0	9.5
Balsam Fir	2.4	6.8
Maple-Red	2.0	8.3
Birch	2.7	8.1

Comments:

-There is an outbreak of Spruce budworm infecting Balsam fir species on this sale. Only currently live trees were cruised.

Operational Periods:

Block 1d, dry soil from Sept. 1 to April 30, operation period may be adjusted with permission, see harvest provisions.

Block	Operational Periods
1a,1b,1c	Dry soil after Road Restrictions or Frozen Ground

Products	No Bid	Total Volume	Appraised Value	Total Value
Total for Blocks 1				
Aspen		805 Cords @	\$21.70 =	\$17,468.50
Balsam Fir	X	90 Cords @	\$5.00 =	\$450.00
Birch	X	94 Cords @	\$5.00 =	\$470.00
Maple-Red	X	91 Cords @	\$5.00 =	\$455.00
Pine-Jack		102 Cords @	\$14.12 =	\$1,440.24
Pine-Norway		65 Cords @	\$22.07 =	\$1,434.55
Spruce-Black	X	30 Cords @	\$7.48 =	\$224.40
Spruce-White	X	21 Cords @	\$11.91 =	\$250.11
SOAV Tamarack	X	12 Cords @	\$1.62 =	\$19.44
Total Appraised Value:				\$22,212.24

C19260068

St. Louis County

C26-651720

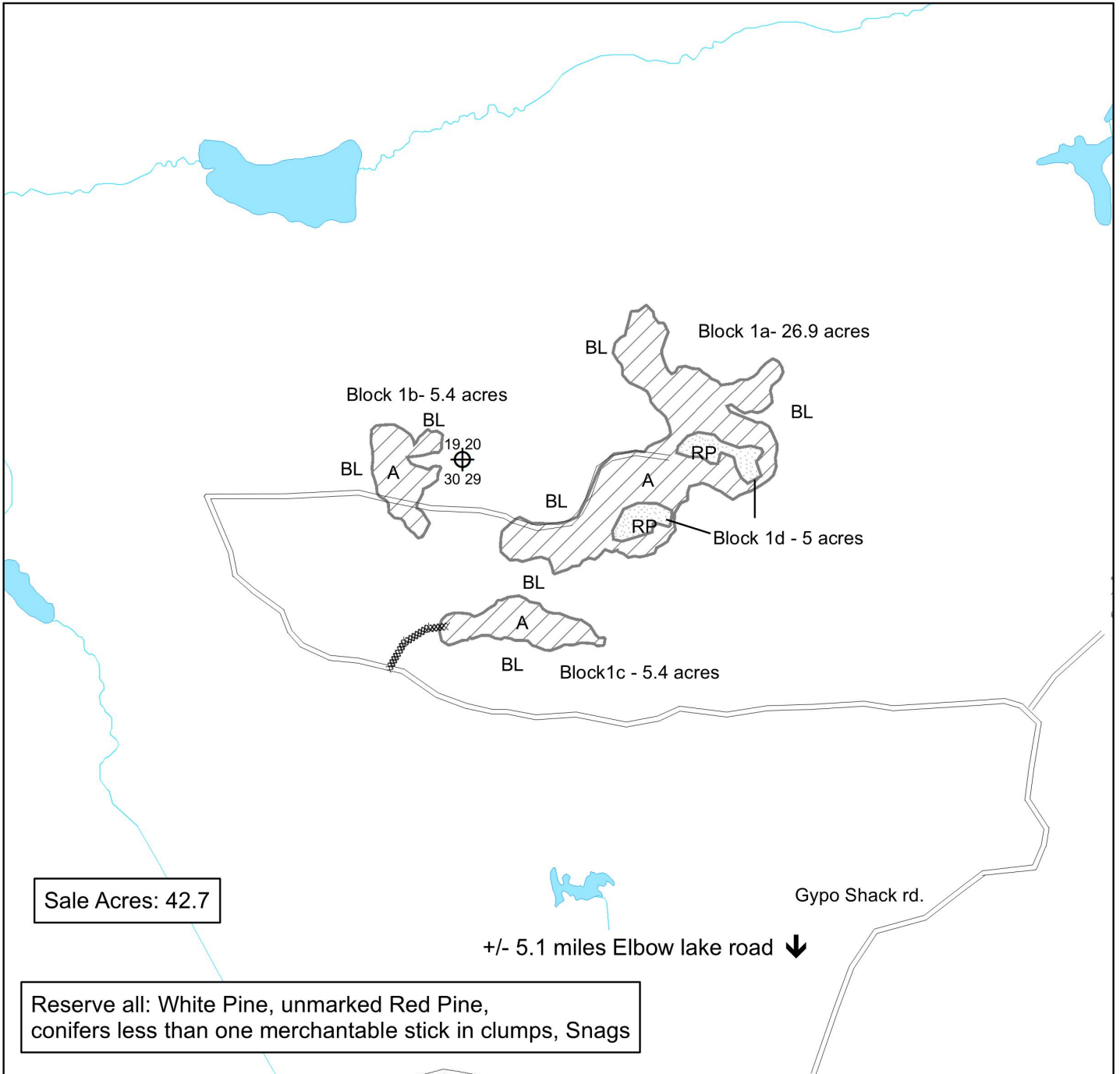

Sale Acres: 42.7

Reserve all: White Pine, unmarked Red Pine, conifers less than one merchantable stick in clumps, Snags

Prepared By:	Casey Anderson
Map Created:	4/23/2026
TRS:	651720
Disclaimer:	This is a compilation of records as they appear in the Saint Louis County Offices affecting the area shown. This drawing is to be used only for reference purposes and the County is not responsible for any inaccuracies herein contained.

	CCT- Clear cut	BL	Painted Blue Line
	MKD- Marked thinning/ orange slash		Section Corner
	proposed access road/new construction	A	Aspen
	Seasonal Woods Road	RP	Red Pine

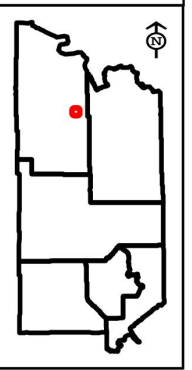



St. Louis County August 13, 2026 Timber Auction

Tract #: 11

E26-601609

Sale Administrator: James Simons

Virginia Area
C19260069

Total Appraised: \$26,575.47

Twp. 60N Rge. 16W Sec. 9

Total Acres: 40.5

Down Payment Required: \$3,986.32

47° 41.589' N 092° 22.459' W

Blocks: 1

Expires: 4/15/2029

Species	Sticks	Dia.
Aspen	4.8	9.1
Balsam Fir	3.1	8.4
Birch	3.5	8.5

Comments:

Access:

The sale is at the end of the North Pike FMR (Dahl Road).

Block	Operational Periods
1	Frozen Ground

Products	No Bid	Total Volume	Appraised Value	Total Value
Total for Blocks 1				
Aspen		1095 Cords @	\$24.11 =	\$26,400.45
Balsam Fir	X	27 Cords @	\$5.66 =	\$152.82
SOAV Birch	X	4 Cords @	\$5.55 =	\$22.20
Total Appraised Value:				\$26,575.47

C19260069

St. Louis County

E26-601609

Block	Acres
01	40.5
Total Acres: 40.5	

Reserve: Snags

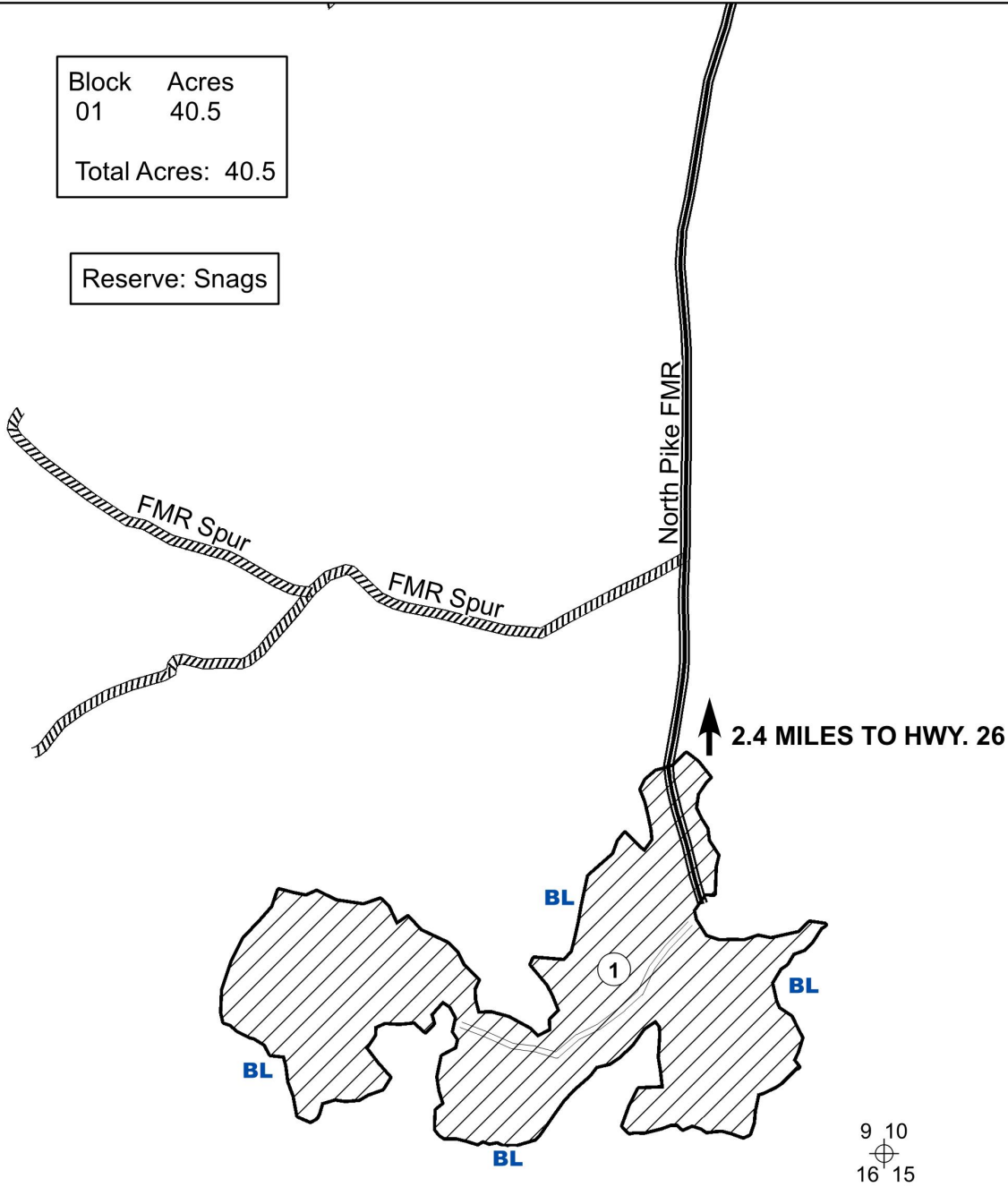

Prepared By: Jim Simons
Map Created: 3/4/2026
TRS: 601609
Disclaimer:
This is a compilation of records as they appear in the Saint Louis County Offices affecting the area shown. This drawing is to be used only for reference purposes and the County is not responsible for any inaccuracies herein contained.

-  HARVEST AREA (CCT)
-  WOODS ROAD
- BL** HARVEST BOUNDARY PAINTED BLUE

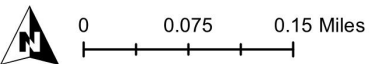
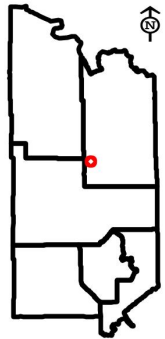



St. Louis County August 13, 2026 Timber Auction

Tract #: 12

V26-551619

Sale Administrator: Karl Rudstrom

Virginia Area
C19260071

Total Appraised: \$53,184.18

Twp. 55N Rge. 16W Sec. 18, 19

Total Acres: 88.8

Down Payment Required: \$7,977.63

Expires: 4/15/2030

47° 14.306' N 092° 25.256' W

Blocks: 3

Species	Sticks	Dia.
Aspen	4.9	10.3
Maple-Red	3.2	10.5
Birch	4.0	9.6
Spruce-White	5.1	11.8
Balsam Fir	4.0	11.1
Spruce-Black	4.2	8.8

Comments:

-The purchaser has the option to purchase this sale as advertised or to purchase all species as Sold On Appraised Volume (SOAV). Optional Products will be included with the SOAV option if advertised.

-This sale is in the Emerald Ash Borer Quarantine Area.

Access:

Dry soil operation in Blocks 1 & 2 may require new road construction with culvert installation, purchaser is encouraged to inspect the site and contact sale administrator for details.

Block	Operational Periods
1 & 2	Dry soil after July 1 or Frozen Ground
3	Frozen Ground

Products	No Bid	Total Volume	Appraised Value	Total Value
Total for Blocks 1, 2, 3				
Aspen		2138 Cords @	\$24.11 =	\$51,547.18
Balsam Fir	X	28 Cords @	\$5.66 =	\$158.48
SOAV Birch	X	70 Cords @	\$5.55 =	\$388.50
SOAV Maple-Red	X	98 Cords @	\$5.00 =	\$490.00
Spruce-Black	X	26 Cords @	\$8.31 =	\$216.06
Spruce-White	X	29 Cords @	\$13.24 =	\$383.96
Total Appraised Value:				\$53,184.18

Volume Per Block	Block 1	Block 2	Block 3
Aspen pulpwood	683	643	812
Balsam Fir pulpwood	3		25
Birch pulpwood	28	26	16
Maple-Red pulpwood	21	37	40
Spruce-Black pulpwood	3	20	3
Spruce-White pulpwood			29

C19260071

St. Louis County

V26-551619

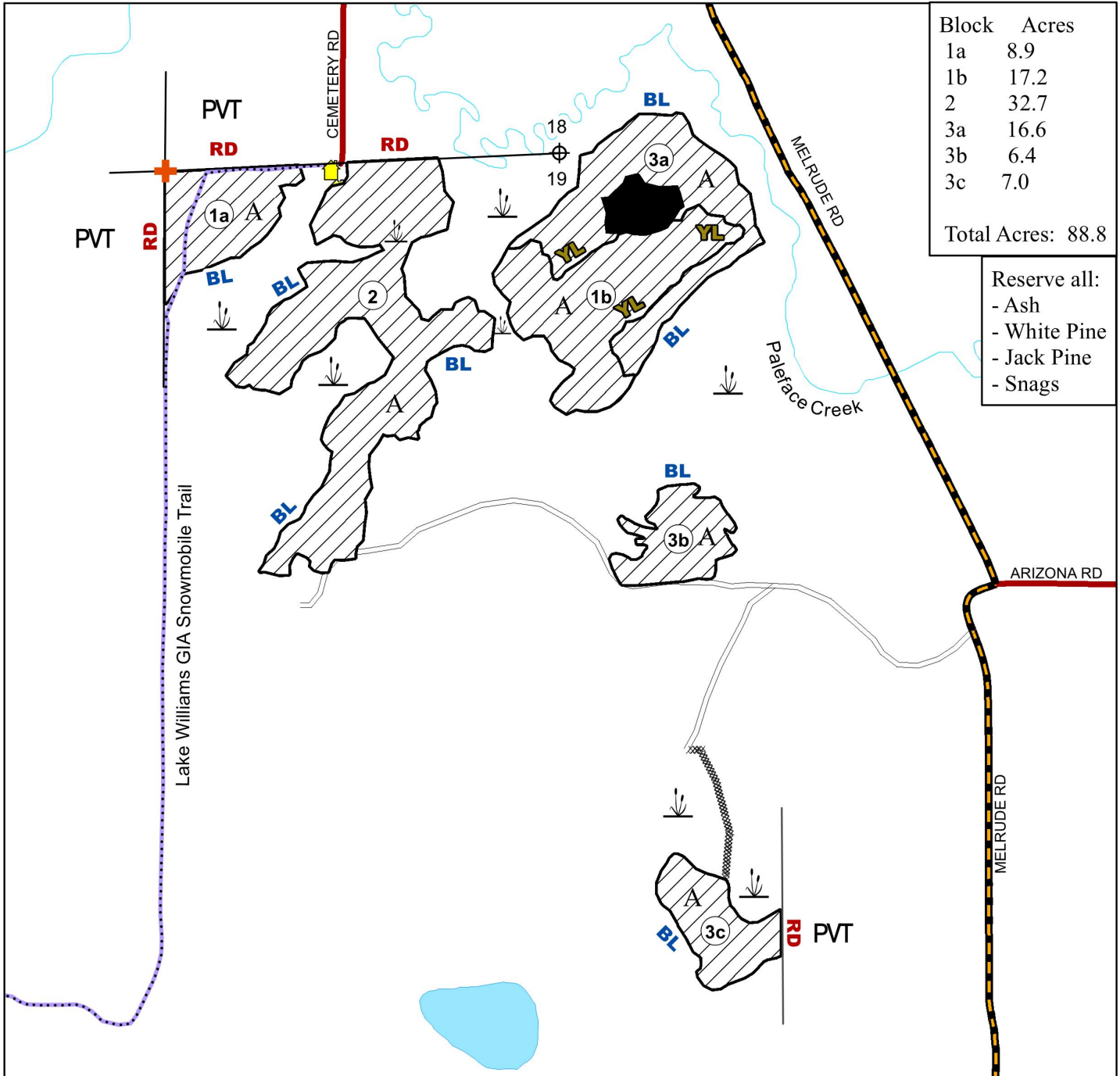

Prepared By: Karl Rudstrom

Map Created: 4/2/2026

TRS: 551619

Disclaimer:
This is a compilation of records as they appear in the Saint Louis County Offices affecting the area shown. This drawing is to be used only for reference purposes and the County is not responsible for any inaccuracies herein contained.

0 0.1 0.2 Miles

- Clearcut
- Cabin Leases
- Painted Blue Line
- Painted Red Line
- Reserve Area (Painted Double Blue)
- Seasonal Woods Road
- Snowmobile Trails
- Proposed Access Road
- Aspen
- Wetland or Marsh
- Section Corner
- Private
- Survey Marker (protect)
- Yellow Painted Block Line

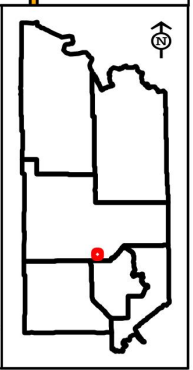



St. Louis County August 13, 2026 Timber Auction

Tract #: 13	B26-531224	Sale Administrator: Anna Nixon
Pike Lake Area C19260075	Total Appraised: \$33,065.32	Twp. 53N Rge. 12W Sec. 23, 24
Total Acres: 82.4	Down Payment Required: \$4,959.80	47° 3.447' N 091° 48.865' W
Blocks: 2	Expires: 4/15/2029	

Species	Sticks	Dia.
Aspen	4.3	9.3
Maple-Sugar	2.3	8.6
Maple-Red	2.4	8.1
Birch	3.3	9.8
Balm Of Gilead	3.3	7.0
Balsam Fir	2.4	6.9

Comments:

- The purchaser has the option to purchase this sale as advertised or to purchase all species as Sold On Appraised Volume (SOAV). Optional Products will be included with the SOAV option if advertised.
- Operations on this sale will be required to use GPS technology to determine the location of unpainted boundaries. See harvest provisions or contact the sale administrator for details.
- There is an outbreak of Spruce budworm infecting balsam species on this sale. Only currently live trees were cruised.
- This sale is in the Emerald Ash Borer Quarantine Area.
- Timber sale has a gated or restrictive access, contact the sale administrator for access details.

Block	Operational Periods
1, 2	Frozen Ground

Products	No Bid	Total Volume	Appraised Value	Total Value
Total for Blocks 1, 2				
Aspen		1256 Cords @	\$24.11 =	\$30,282.16
Balm Of Gilead		30 Cords @	\$24.11 =	\$723.30
Balsam Fir	X	28 Cords @	\$5.00 =	\$140.00
SOAV Birch	X	56 Cords @	\$5.55 =	\$310.80
SOAV Maple-Red	X	113 Cords @	\$5.00 =	\$565.00
SOAV Maple-Sugar	X	155 Cords @	\$5.54 =	\$858.70
Spruce-White	X	14 Cords @	\$13.24 =	\$185.36
Total Appraised Value:				\$33,065.32

Volume Per Block	Block 1	Block 2
Aspen pulpwood	622	634
Balm Of Gilead pulpwood	15	15
Balsam Fir pulpwood	14	14
Birch pulpwood	28	28
Maple-Red pulpwood	56	57
Maple-Sugar pulpwood	77	78
Spruce-White pulpwood	7	7

C19260075

St. Louis County

B26-531224

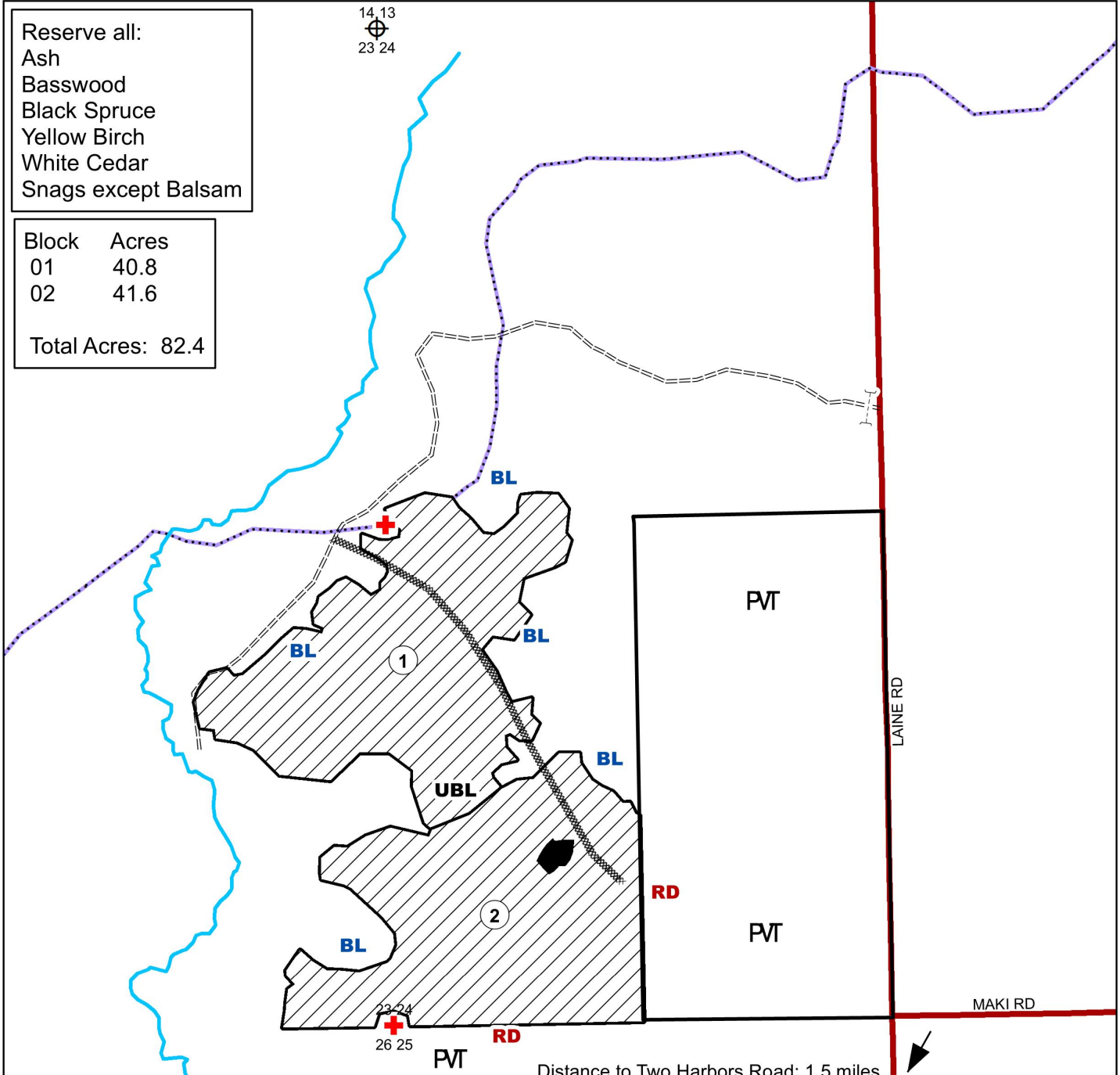

Reserve all:
Ash
Basswood
Black Spruce
Yellow Birch
White Cedar
Snags except Balsam

Block	Acres
01	40.8
02	41.6
Total Acres: 82.4	

14,13
23,24

Prepared By: **Anna Nixon**
Map Created: 3/30/2026
TRS: 531224
Disclaimer:
This is a compilation of records as they appear in the Saint Louis County Offices affecting the area shown. This drawing is to be used only for reference purposes and the County is not responsible for any inaccuracies herein contained.

- Clearcut
- BL Painted Blue Line
- RD Painted Red Line
- Reserve Area
- UBL Unpainted Block Line
- PVT Private
- Gate
- Survey Marker (protect)
- Seasonal Woods Road
- Old Grade
- Snowmobile Trails
- Stream

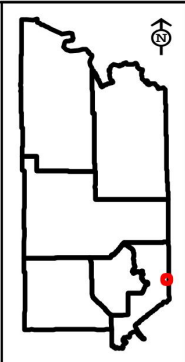



St. Louis County August 13, 2026 Timber Auction

Tract #: 14	K26-531427	Sale Administrator: Timothy Rutka
Pike Lake Area C19260081	Total Appraised: \$69,113.84	Twp. 53N Rge. 14W Sec. 22, 27, 28
Total Acres: 113.8	Down Payment Required: \$10,367.08	47° 3.159' N 092° 6.384' W
Blocks: 6	Expires: 4/15/2030	

Species	Sticks	Dia.
Aspen	5.0	13.4
Pine-White	6.6	22.8
Pine-Norway	7.1	26.7
Birch	4.2	11.1
Maple-Red	3.4	11.5
Spruce-White	5.5	15.5

Comments:

- The Purchaser has the option to purchase this sale as advertised or to purchase all species except for White and Red Pine as Sold On Appraised Volume (SOAV). Optional Products will be included with the SOAV option if advertised.
- Operations on this sale will be required to use GPS technology to determine the location of unpainted boundaries. See harvest provisions or contact the sale administrator for details.
- Roundwood chipping of scaled species will be allowed if scaling requirements are met.
- A minimum \$2000.00 of the downpayment will be retained and will be held until the satisfactory completion of the contract.
- There is an outbreak of Spruce budworm infecting balsam fir species on this sale. Only currently live trees were cruised.

Operational Periods:

Pine Harvesting in all blocks must occur during Dry soil from September 1 to April 30, operation may be adjusted with permission, see harvest provisions.

Block	Operational Periods
1,2,3,4,5,6	Dry soil after June 1 or Frozen Ground

Products	No Bid	Total Volume	Appraised Value	Total Value
Total for Blocks 1, 2, 3, 4, 5, 6				
Aspen		1429 Cords @	\$26.52 =	\$37,897.08
Balm Of Gilead		3 Cords @	\$26.52 =	\$79.56
Balsam Fir	X	24 Cords @	\$5.00 =	\$120.00
SOAV Birch	X	162 Cords @	\$6.11 =	\$989.82
SOAV Maple-Red	X	62 Cords @	\$5.50 =	\$341.00
Pine-Norway		361 Cords @	\$26.98 =	\$9,739.78
Pine-White		520 Cords @	\$37.83 =	\$19,671.60
Spruce-White	X	55 Cords @	\$5.00 =	\$275.00
Total Appraised Value:				\$69,113.84

Volume Per Block	Block 1	Block 2	Block 3	Block 4	Block 5	Block 6
Aspen pulpwood	531	538	37	156	33	134
Balm Of Gilead pulpwood						3
Balsam Fir pulpwood	10	7	4	3		
Birch pulpwood		23	4	93	35	7
Maple-Red pulpwood	20	12	8	4	15	3
Pine-Norway pulpwood	11	26	205	91	13	15
Pine-White pulpwood		23	200	159	128	10
Spruce-White pulpwood	15		5	9	21	5

C19260081

St. Louis County

K26-531427

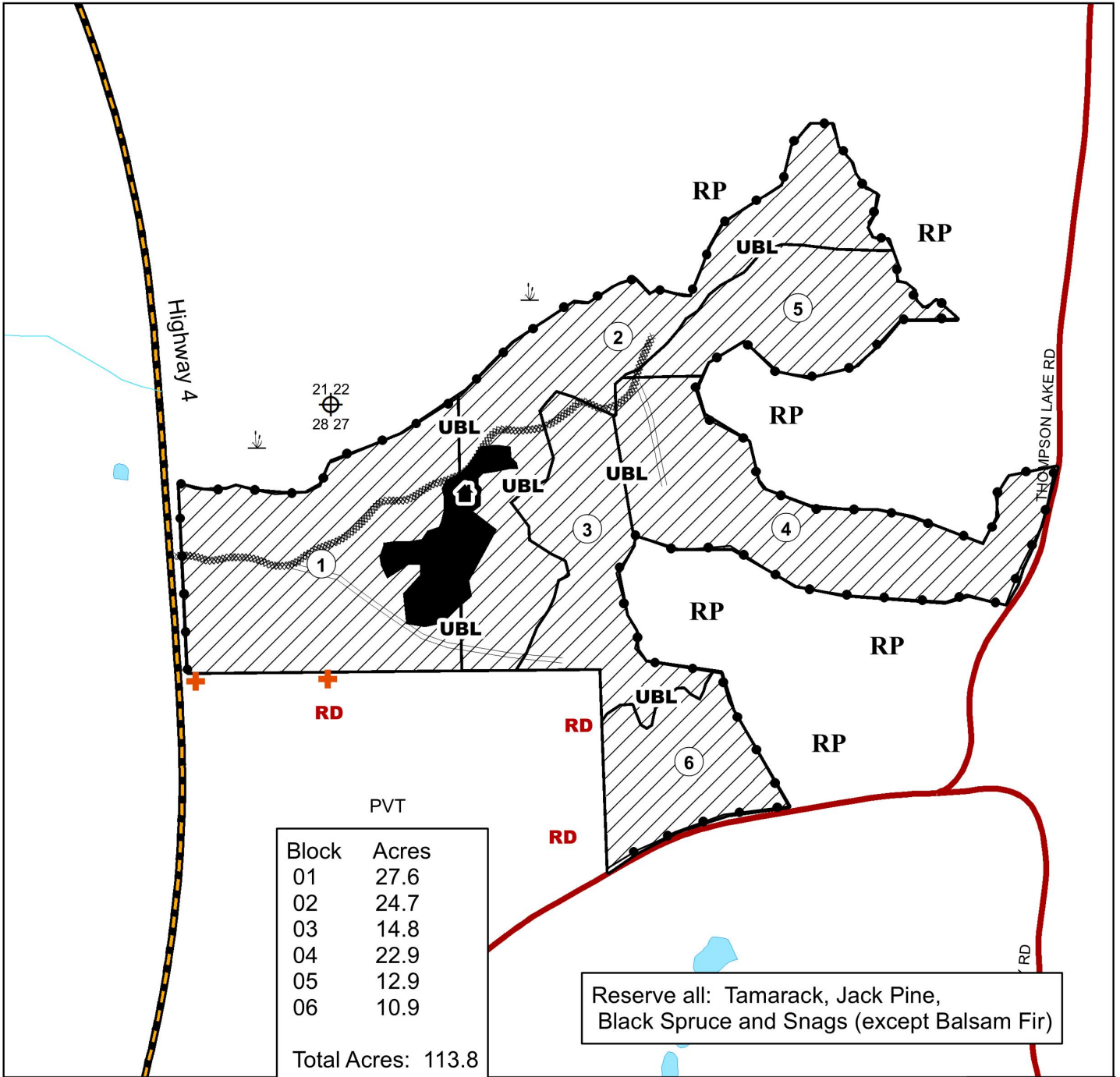

Prepared By: Timothy Rutka

Map Created: 5/14/2026

TRS: 531427

Disclaimer:
This is a compilation of records as they appear in the Saint Louis County Offices affecting the area shown. This drawing is to be used only for reference purposes and the County is not responsible for any inaccuracies herein contained.

0 0.075 0.15 Miles

clear cut

Reserve Area (painted double blue)

PVT Private

RD Painted Red Line

Existing Designated Access

New Construction Road

RP Red Pine

Unpainted Boundary

lease cabin

Survey Marker

UBL Unpainted Block Lines

Wetland or Marsh

This page intentionally left blank.

Round C

Tracts 15-20



St. Louis County August 13, 2026 Timber Auction

Tract #: 15

C26-631930

Sale Administrator: Shontel Adam

Virginia Area
C19260064

Total Appraised: \$13,141.92

Twp. 63N Rge. 19W Sec. 30

Down Payment Required: \$1,971.29

Total Acres: 77.3

Expires: 4/15/2030

47° 54.91' N 092° 48.689' W

Blocks: 2

Species	Sticks	Dia.
Spruce-Black	4.0	7.8
Aspen	4.4	9.7
Maple-Red	2.5	9.7
Birch	3.1	8.1
Balsam Fir	3.4	14.9
Tamarack	4.5	9.1

Comments:

-This sale has been turned back and is re-offered with reduced prices.

Block	Operational Periods
2	Frozen Ground
1	Dry soil after June 1 or Frozen Ground

Products	No Bid	Total Volume	Appraised Value	Total Value
Total for Blocks 1, 2				
Aspen		391 Cords @	\$19.29 =	\$7,542.39
Balsam Fir	X	121 Cords @	\$5.00 =	\$605.00
Birch	X	130 Cords @	\$5.00 =	\$650.00
Maple-Red	X	175 Cords @	\$5.00 =	\$875.00
Spruce-Black		492 Cords @	\$6.65 =	\$3,271.80
Spruce-White	X	15 Cords @	\$10.59 =	\$158.85
Tamarack	X	27 Cords @	\$1.44 =	\$38.88
Total Appraised Value:				\$13,141.92

Volume Per Block	Block 1	Block 2
Aspen pulpwood	391	
Balsam Fir pulpwood	121	
Birch pulpwood	129	1
Maple-Red pulpwood	175	
Spruce-Black pulpwood		492
Spruce-White pulpwood	15	
Tamarack pulpwood		27

C19260064

St. Louis County
C26-631930

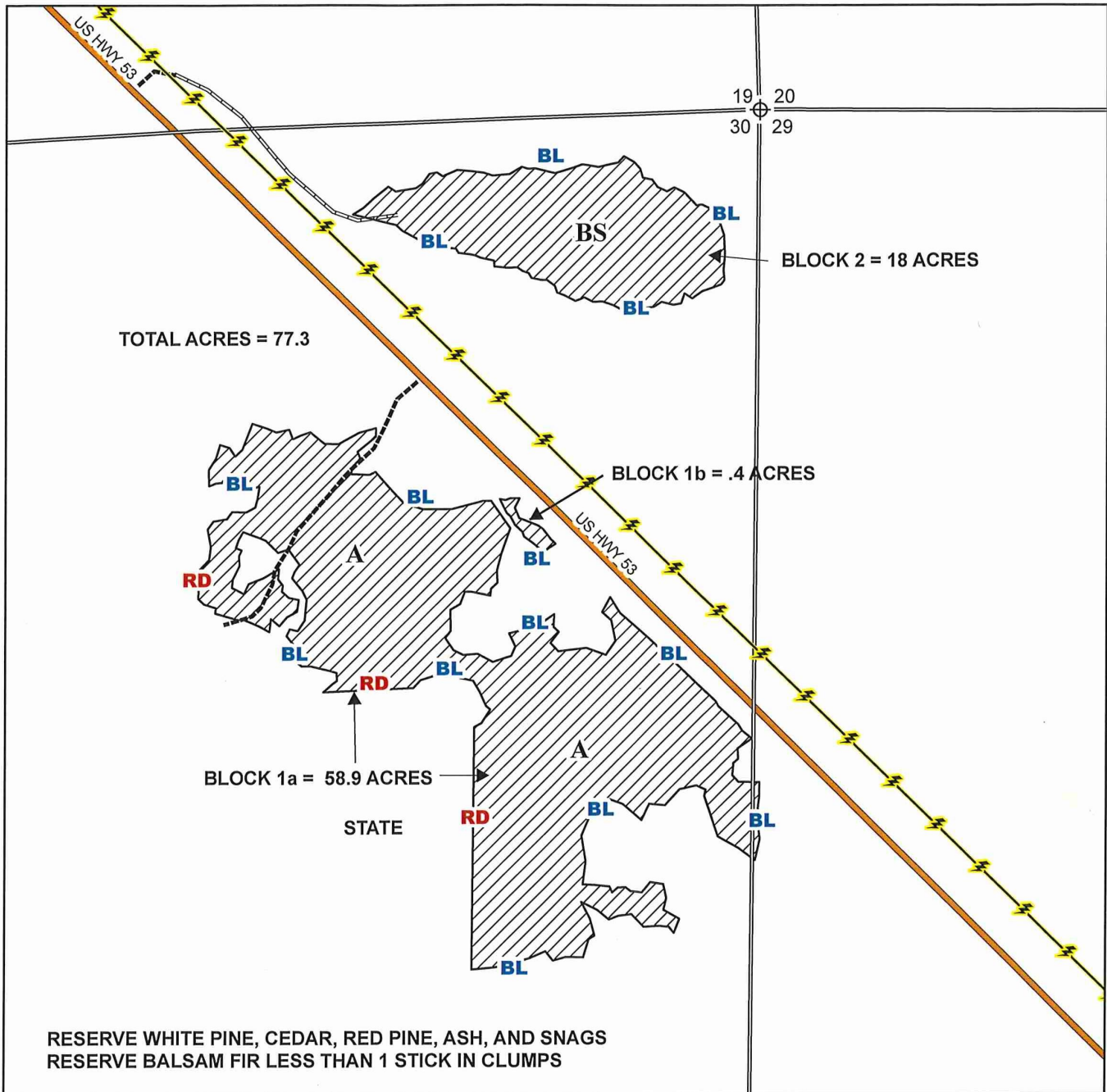

Prepared By: SHONTEL ADAM
Map Created: 5/20/2026
TRS: 631930
Disclaimer:
This is a compilation of records as they appear in the Saint Louis County Offices affecting the area shown. This drawing is to be used only for reference purposes and the County is not responsible for any inaccuracies herein contained.

1 in = 0.125 miles
0 0.25 Miles

- BL** - HARVEST AREA CLEARCUT-CCT- BOUNDARIES PAINTED BLUE OR RED
- RD** - EXISTING WOODS ROAD
- BS** - BLACK SPRUCE COVERTYPE
- A** - ASPEN COVERTYPE
- \oplus - SECTION CORNER
- \leftarrow -POWERLINE
- \leftarrow -PROPOSED ACCESS - NEW WINTER CONSTRUCTION

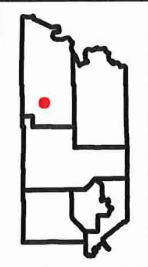



St. Louis County August 13, 2026 Timber Auction

Tract #: 16	V26-551529	Sale Administrator: Kyle Andrews
Virginia Area	Total Appraised: \$30,969.04	Twp. 55N Rge. 15W Sec. 19, 29, 30
C19260070	Down Payment Required: \$4,645.36	47° 13.4' N 092° 16.967' W
Total Acres: 76.5	Expires: 4/15/2030	
Blocks: 4		

Species	Sticks	Dia.
Aspen	4.6	11.9
Pine-Norway	6.8	15.8
Balsam Fir	3.5	10.4
Birch	3.6	9.7
Spruce-White	5.1	12.8
Pine-White	6.9	19.1

Comments:

- A minimum \$2000.00 of the downpayment will be retained and will be held until the satisfactory completion of the contract.
- This sale is in the Emerald Ash Borer Quarantine Area.
- This sale is being reoffered with REDUCED PRICES.

Access:

Extensive road work will be needed if sale is operated during dry soil conditions after July 1st, please contact the sale administrator for details.

Block	Operational Periods
1-3	Dry soil after July 1 or Frozen Ground
4	Dry soil from August 1 to March 15. Earlier operation may be allowed, see harvest provisions.

Products	No Bid	Total Volume	Appraised Value	Total Value
Total for Blocks 1, 2, 3, 4				
SOAV Ash	X	5 Cords @	\$5.00 =	\$25.00
Aspen		1205 Cords @	\$16.88 =	\$20,340.40
Balm Of Gilead		46 Cords @	\$16.88 =	\$776.48
Balsam Fir	X	274 Cords @	\$5.00 =	\$1,370.00
SOAV Birch	X	119 Cords @	\$5.00 =	\$595.00
SOAV Maple-Red	X	26 Cords @	\$5.00 =	\$130.00
Pine-Jack		23 Cords @	\$10.98 =	\$252.54
Pine-Norway		363 Cords @	\$17.17 =	\$6,232.71
Pine-White		26 Cords @	\$24.07 =	\$625.82
SOAV Spruce-White	X	67 Cords @	\$9.27 =	\$621.09
Total Appraised Value:				\$30,969.04

Volume Per Block	Block 1	Block 2	Block 3	Block 4
Ash pulpwood		5		
Aspen pulpwood	182	641	379	3
Balm Of Gilead pulpwood		46		
Balsam Fir pulpwood	28	157	72	17
Birch pulpwood	9	36	49	25
Maple-Red pulpwood		8	18	
Pine-Jack pulpwood				23
Pine-Norway pulpwood				363
Pine-White pulpwood				26
Spruce-White pulpwood	4	25	35	3



St. Louis County August 13, 2026 Timber Auction

Tract #: 17

V26-561533

Sale Administrator: Thomas Salzer

Virginia Area
C19260072

Total Appraised: \$15,899.59

Twp. 56N Rge. 15W Sec. 33, 34

Down Payment Required: \$2,384.94

Total Acres: 45.6

Expires: 4/15/2029

47° 17.387' N 092° 14.449' W

Blocks: 1

Species	Sticks	Dia.
Aspen	5.0	13.6
Birch	2.7	9.2
Balsam Fir	2.2	7.9
Spruce-White	4.9	13.7
Spruce-Black	2.6	8.3

Comments:

-The purchaser has the option to purchase this sale as advertised or to purchase all species as Sold On Appraised Volume (SOAV). Optional Products will be included with the SOAV option if advertised.

-Operations on this sale will be required to use GPS technology to determine the location of unpainted boundaries. See harvest provisions or contact the sale administrator for details.

-Sale has been turned back and reoffered with REDUCED PRICES.

Access:

Approximately 0.8 miles of winter road construction.

Block	Operational Periods
1	Frozen Ground

Products	No Bid	Total Volume	Appraised Value	Total Value
Total for Blocks 1				
Aspen		630 Cords @	\$21.70 =	\$13,671.00
SOAV Balsam Fir	X	96 Cords @	\$5.10 =	\$489.60
SOAV Birch	X	101 Cords @	\$5.00 =	\$505.00
SOAV Spruce-Black	X	36 Cords @	\$7.48 =	\$269.28
SOAV Spruce-White	X	81 Cords @	\$11.91 =	\$964.71
Total Appraised Value:				\$15,899.59



St. Louis County August 13, 2026 Timber Auction

Tract #: 18

V26-582023

Sale Administrator: Karl Rudstrom

Virginia Area
C19260074

Total Appraised: \$40,152.08

Twp. 58N Rge. 20W Sec. 23, 24

Down Payment Required: \$6,022.81

Total Acres: 95.2

Expires: 4/15/2029

47° 29.421' N 092° 49.629' W

Blocks: 3

Species	Sticks	Dia.
Aspen	4.8	11.8
Birch	3.5	9.7
Maple-Red	2.5	9.4
Balsam Fir	2.5	7.9
Ash	3.2	7.7
Spruce-White	5.1	15.0

Comments:

- A minimum \$2000.00 of the downpayment will be retained and will be held until the satisfactory completion of the contract.

-This sale is in the Emerald Ash Borer Quarantine Area.

-This sale is being reoffered with REDUCED PRICES.

-Timber sale has a gated or restrictive access, contact the sale administrator for access details.

-Purchaser must obtain additional Access/Use License Agreement from RGGG prior to beginning work on the sale involving insurance requirements and fees.

Contact sale administrator for details.

Block	Operational Periods
1-3	Frozen Ground

Products	No Bid	Total Volume	Appraised Value	Total Value
Total for Blocks 1, 2, 3				
SOAV Ash	X	64 Cords @	\$5.00 =	\$320.00
Aspen		1935 Cords @	\$19.29 =	\$37,326.15
Balsam Fir	X	130 Cords @	\$5.00 =	\$650.00
SOAV Birch	X	159 Cords @	\$5.00 =	\$795.00
SOAV Maple-Red	X	155 Cords @	\$5.00 =	\$775.00
Spruce-White	X	27 Cords @	\$10.59 =	\$285.93
Total Appraised Value:				\$40,152.08

Volume Per Block	Block 1	Block 2	Block 3
Ash pulpwood	48	13	3
Aspen pulpwood	696	486	753
Balsam Fir pulpwood	74	54	2
Birch pulpwood	38	81	40
Maple-Red pulpwood	83	44	28
Spruce-White pulpwood	16	7	4

C19260074

St. Louis County
V26-582023

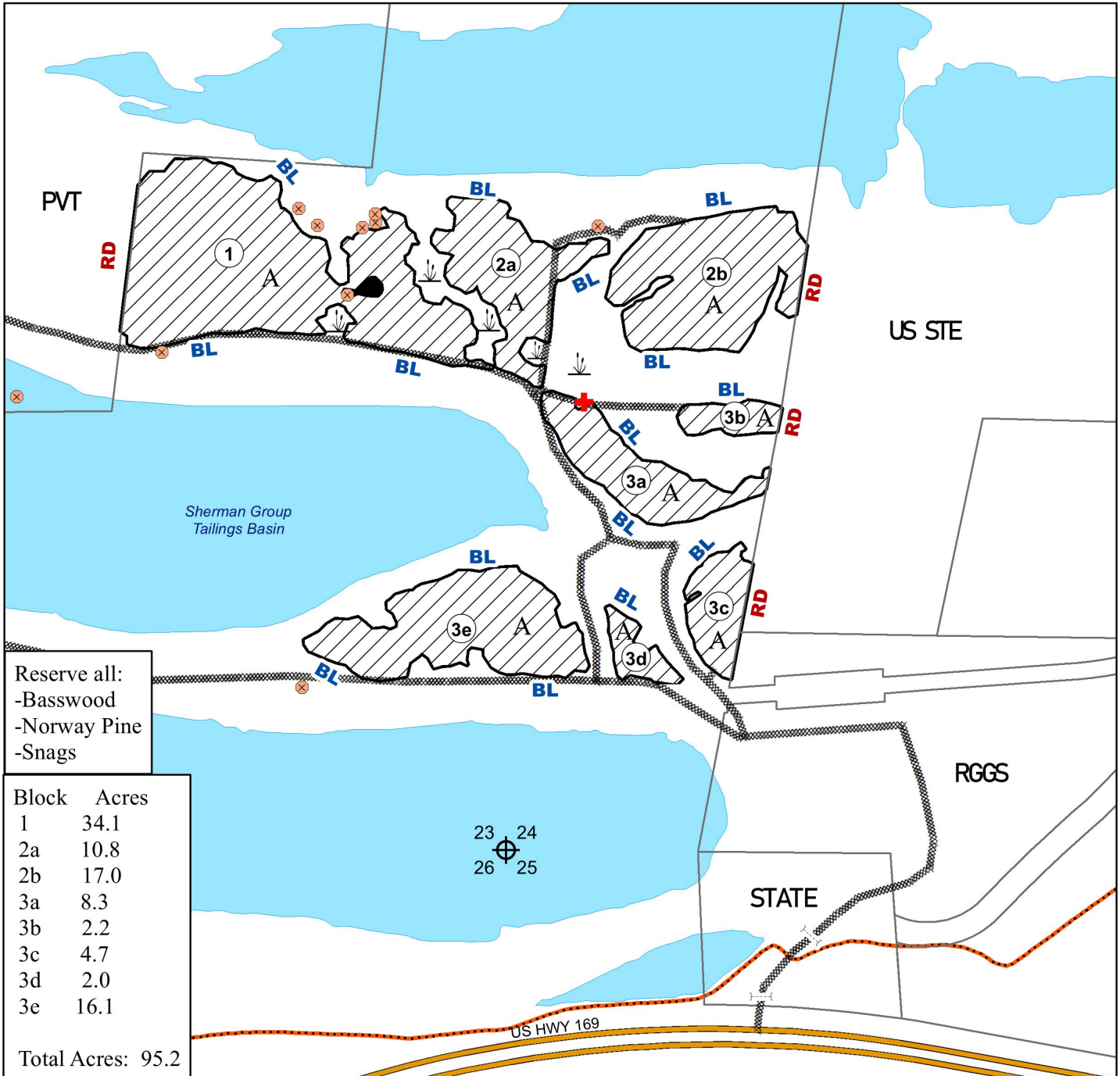

Prepared By: Karl Rudstrom
Map Created: 10/7/2025
TRS: 582023&24
Disclaimer:
This is a compilation of records as they appear in the Saint Louis County Offices affecting the area shown. This drawing is to be used only for reference purposes and the County is not responsible for any inaccuracies herein contained.

Clearcut	Private
Reserve Area (Painted Double Blue)	Aspen
Painted Red Line	Gate
Painted Blue Line	Mine Shaft
Section Corner	Mesabi Trail
Survey Marker (protect)	Designated Access Road (Existing Woods Road)
Wetland or Marsh	

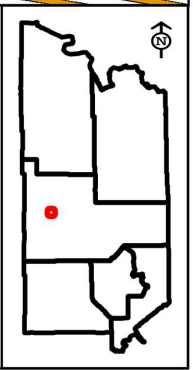



St. Louis County August 13, 2026 Timber Auction



Tract #: 19

F26-542015

Sale Administrator: Drake Schroeder

Pike Lake Area
C19260080

Total Appraised: \$36,541.75
Down Payment Required: \$5,481.26
Expires: 4/15/2029

Twp. 54N Rge. 20W Sec. 3, 4, 5, 8, 9, 10, 15

Total Acres: 97.3

47° 10.597' N 092° 52.415' W

Blocks: 2

Species	Sticks	Dia.
Aspen	6.1	10.4
Ash	4.3	10.0
Optional-Ash	4.0	10.7
Optional-Birch	4.6	12.3
Optional-Aspen	5.5	11.4
Balm Of Gilead	4.7	9.4

Comments:

- The purchaser has the option to purchase this sale as advertised or to purchase all species as Sold On Appraised Volume (SOAV) including Optional Products if advertised.
- The decision to purchase the Optional Block #2 is to be determined and paid for prior to opening the entire sale or an individual block. Optional products not purchased will be considered reserve trees and damage penalties can apply.
- Operations on this sale will be required to use GPS technology to determine the location of unpainted boundaries for Block 2. See harvest provisions or contact the sale administrator for details.
- \$2,000 of the downpayment will be retained and will be held until the satisfactory completion of the contract.
- This sale is being reoffered with reduced prices and optional blocks.
- Timber sale has a gated or restrictive access, contact the sale administrator for access details.

Access:

Access for portions of this sale will be from the snowmobile trail/old railroad grade off Arkola Road, which is raised, level, and graveled. The remainder will be accessed through a gate on Lahti Road, and adjacent to a private drive off Ash Lane. Letters granting permission for these accesses have been received from all affected parties.

Block	Operational Periods
1, 2, 3	Frozen Ground

Products		No Bid	Total Volume	Appraised Value	Total Value
Total for Blocks 1, 3					
SOAV	Ash	X	364 Cords @	\$2.50 =	\$910.00
	Aspen		1473 Cords @	\$21.60 =	\$31,816.80
	Balm Of Gilead		143 Cords @	\$21.60 =	\$3,088.80
	Balsam Fir	X	125 Cords @	\$5.00 =	\$625.00
SOAV	Birch	X	17 Cords @	\$5.95 =	\$101.15
Total Appraised Value:					\$36,541.75

Optional Products		No Bid	Total Volume	Appraised Value	Total Value
Total for Optional Blocks 2					
SOAV	Ash	X	274 Cords @	\$2.50 =	\$685.00
	Aspen		92 Cords @	\$21.60 =	\$1,987.20
SOAV	Birch	X	122 Cords @	\$5.95 =	\$725.90
	Balm Of Gilead		36 Cords @	\$21.60 =	\$777.60
	Balsam Fir	X	29 Cords @	\$5.00 =	\$145.00
Total Appraised Value:					\$4,320.70

Optional products will not be included into the 15% downpayment of the appraised value and will not be factored into the bid value.

Volume Per Block	Block 1	Block 3
Ash pulpwood		364
Aspen pulpwood	1,037	436
Balm Of Gilead pulpwood		143
Balsam Fir pulpwood	39	86
Birch pulpwood	6	11

Optional Volume Per Block	Block 2
Ash pulpwood	274
Aspen pulpwood	92
Balm Of Gilead pulpwood	36
Balsam Fir pulpwood	29
Birch pulpwood	122

C19260080

St. Louis County
F26-542015

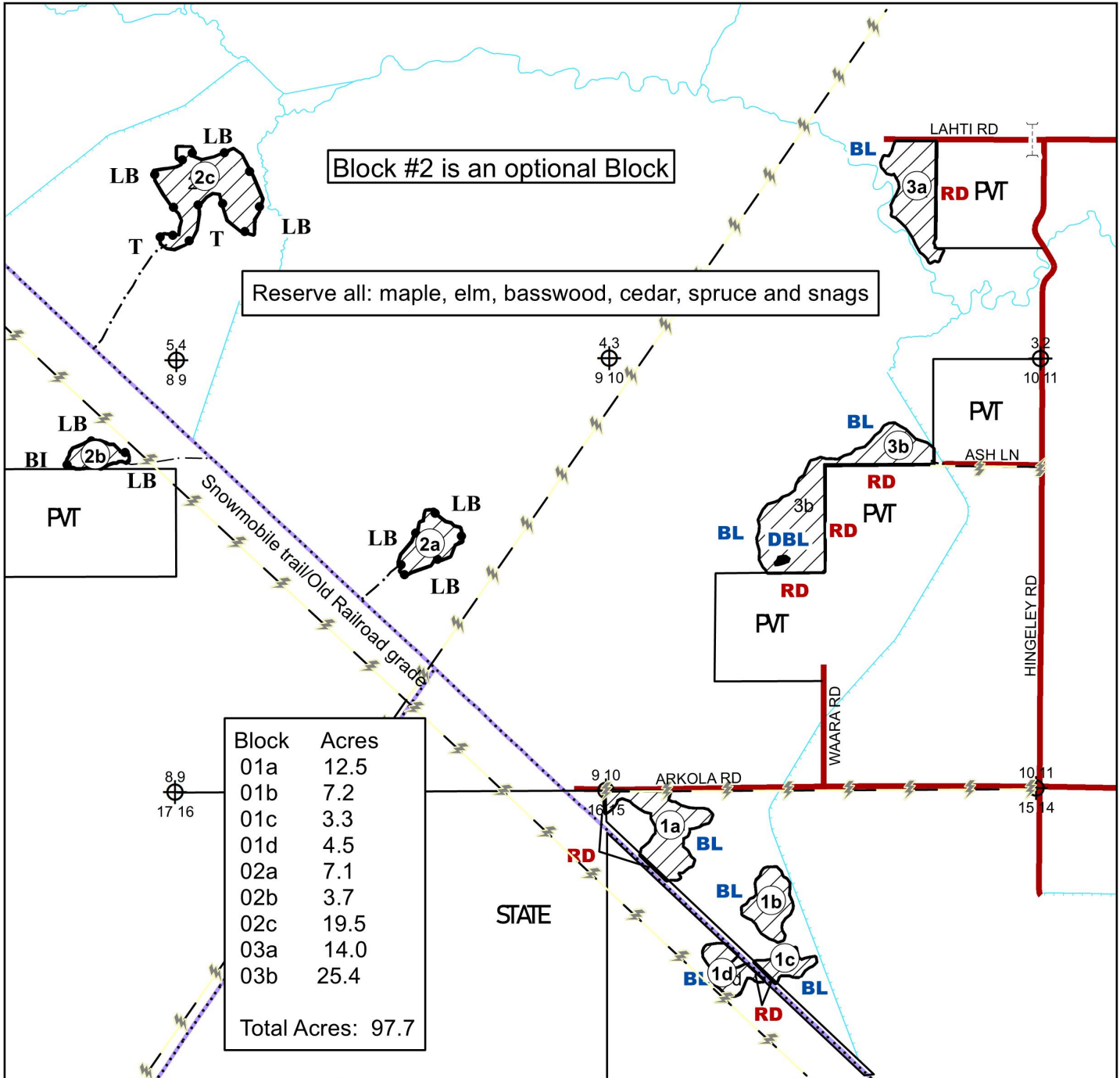

Prepared By: Drake Schroeder

Map Created: 5/18/2026

TRS: 54-20-15

Disclaimer:
This is a compilation of records as they appear in the Saint Louis County Offices affecting the area shown. This drawing is to be used only for reference purposes and the County is not responsible for any inaccuracies herein contained.

0 0.125 0.25 0.5 Miles

Clearcut	Reserve Area	PVT Private
Winter Road Spur (proposed)	Powerline	
Snowmobile Trails		
BL Painted Blue Line	RD Painted Red Line	Adjacent to unpainted blue
DBL Painted Double Blue Line	LB Lowland Brush	
Unpainted Boundary	T Tamarack	
Stream or ditch	BI Birch	
Gate		

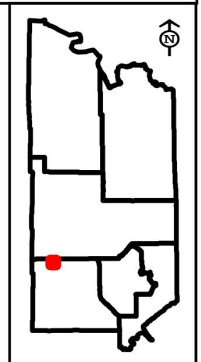



St. Louis County August 13, 2026 Timber Auction

Tract #: 20	B26-531302	Sale Administrator: Robert Benson
Pike Lake Area C19260076	Total Appraised: \$4,925.34	Twp. 53N Rge. 13W Sec. 2
Total Acres: 35.2	Down Payment Required: \$738.80	47° 6.113' N 091° 57.429' W
Blocks: 1	Expires: 4/15/2029	

Species	Sticks	Dia.
Spruce-Black	3.3	6.6
Tamarack	3.4	7.4
Balsam Fir	2.8	7.0

Comments:

-The purchaser has the option to purchase this sale as advertised or to purchase all species as Sold On Appraised Volume (SOAV). Optional Products will be included with the SOAV option if advertised.

-This sale is a reoffer with reduced pricing.

Access:

Access will be from the Lieung FMR, and the sale is located approximately 2 1/4 miles off from Hwy 44.

Block	Operational Periods
1	Frozen Ground

Products		No Bid	Total Volume	Appraised Value	Total Value
Total for Blocks 1					
SOAV	Balsam Fir	X	9 Cords @	\$5.10 =	\$45.90
	Spruce-Black		648 Cords @	\$7.48 =	\$4,847.04
SOAV	Tamarack	X	20 Cords @	\$1.62 =	\$32.40
Total Appraised Value:					\$4,925.34

C19260076

St. Louis County

B26-531302

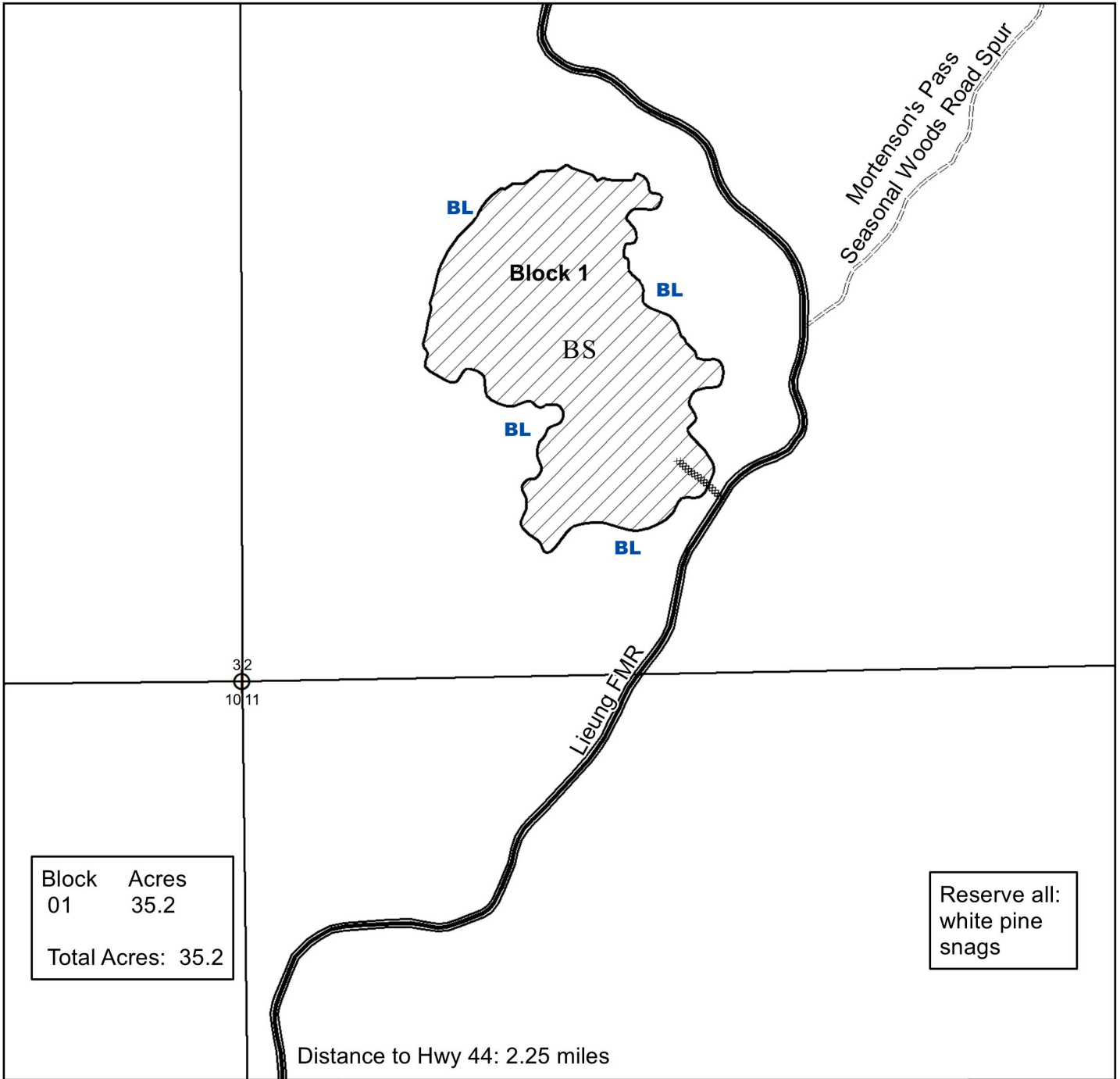

Block	Acres
01	35.2
Total Acres: 35.2	

Reserve all:
white pine
snags

Prepared By: **Robert Benson**

Map Created: 11/19/2025

TRS: 531302

Disclaimer:
This is a compilation of records as they appear in the Saint Louis County Offices affecting the area shown. This drawing is to be used only for reference purposes and the County is not responsible for any inaccuracies herein contained.

0 0.075 0.15 Miles

	Clearcut		Proposed Winter Access
BS	Black Spruce	BL	Painted Blue Line
	Section Corner		

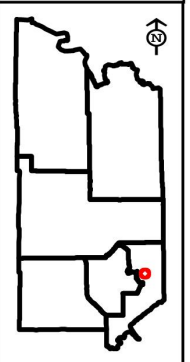

This page intentionally left blank.

Tract Locations

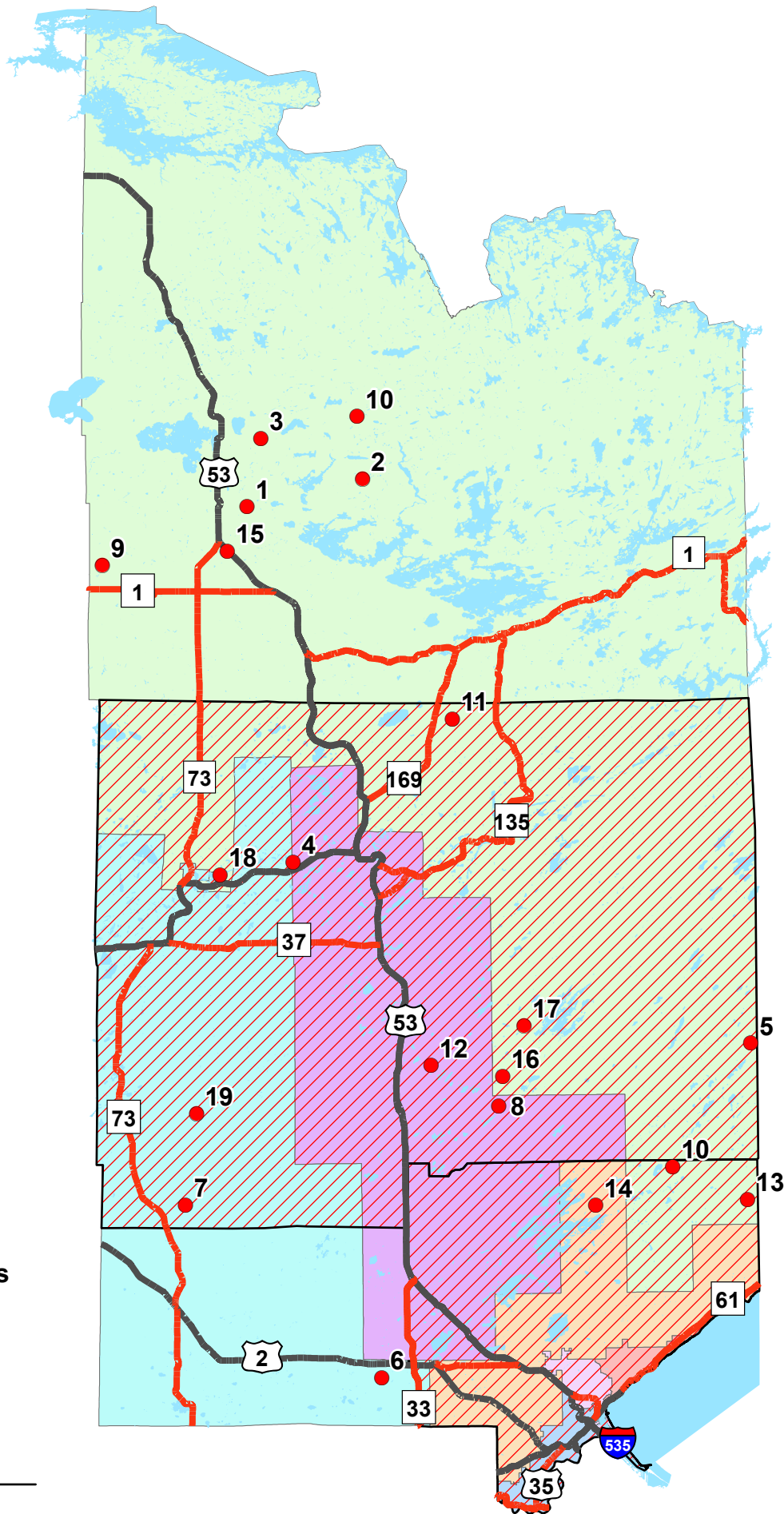

Commissioner Districts

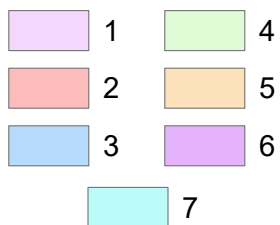

 Tracts

 Emerald Ash Borer Quarantine





S A I N T
LOUIS ♦
COUNTY
M I N N E S O T A

Land and Minerals Department

Intermediate Oral Timber Auction



11:00 A.M.
August 13, 2026
Cotton Town Hall
Cotton, MN



PLEASE NOTE:

**Pre-Registration (enclosed) for
Rounds A and B Required!**

**Decisions for sales offering the SOAV
option must be made the day of sale
when making down payment.**

Barrier Free: All St. Louis County Timber Auctions are accessible to people with disabilities. Attempts will be made to accommodate any other individual needs for special services. Contact the St. Louis County Land and Minerals Department (218-726-2606) prior to the auction, so necessary arrangements can be made.